

ITEMS INCLUDED

- Power Supply Unit
- AC Plug
- Instructions
- Female Pigtail Splice Cable
- Power Supply Mounting Bracket

TOOLS REQUIRED

- Wire Cutters / Crimpers
 - Mounting Screws
 - *Screwdriver, or Power Drill with *Bit
- (*type depends on your chosen mounting hardware)



TO REDUCE THE RISK OF ELECTRIC SHOCK,
DO NOT DISASSEMBLE
NO USER SERVICEABLE PARTS INSIDE.
REFER SERVICING TO QUALIFIED SERVICE PERSONNEL.

1. Before any installation or maintenance work, please disconnect your system from the utility. Ensure that it can't be reconnected inadvertently!

2. Installation and service should be done by qualified personnel only. All work should conform to local codes.

3. Using replacement parts and/or accessories not approved of by Clinton Electronics may void warranty.

4. Mount the unit in an area that cannot be easily accessed by non-qualified personnel.

5. Do not install power supplies in places with high moisture or near water.

6. Do not install power supplies in places with high ambient temperature or near fire source.

7. Do not "daisy chain" power runs to monitors. All power runs from each display must go directly to the Power Supply.

Cable Guideline:
In most cases the CE-PS90 can safely power LCDs or PVMs up to 67 Watts. For best results, use only high-quality 18 gauge cable or larger.

1. CONFIRM POWER REQUIREMENTS

If the monitor or PVM you are powering is a 24 volt DC monitor and draws less than 67 watts (2.79 amps), the CE-PS90 can power it. If you are unsure, call Clinton Technical Support at 1-800-549-6393.

2. NO-SPLICE POWER

If the device you are powering is located within 3 feet of the wall outlet, simply plug the AC cord into the wall outlet. There is no need for splicing on the included pigtail connector.

3. SPLICING GUIDELINES

If the device is to be mounted further than the AC power cord can reach (3'), then you can run 2-conductor wire and splice the included pigtail onto your wire and connect to the DC output from the power supply. Use the following guidelines for determining maximum wire runs.

For powering a 0.8A device		
Wire Gauge	Voltage drop per 100 ft	Max. Cable length (10% voltage drop)
18 AWG	1.02 Volts	238 feet
16 AWG	0.64 Volts	375 feet

For powering a 2.0A device		
Wire Gauge	Voltage drop per 100 ft	Max. Cable length (10% voltage drop)
18 AWG	2.55 Volts	95 feet
16 AWG	1.61 Volts	150 feet
14 AWG	1.01 Volts	238 feet

4. MOUNT POWER SUPPLY

Place the power supply within 3 feet from your desired wall outlet. If desired, slide the included mounting bracket over the power supply and attach it to your mounting surface using 4 fasteners (not included).

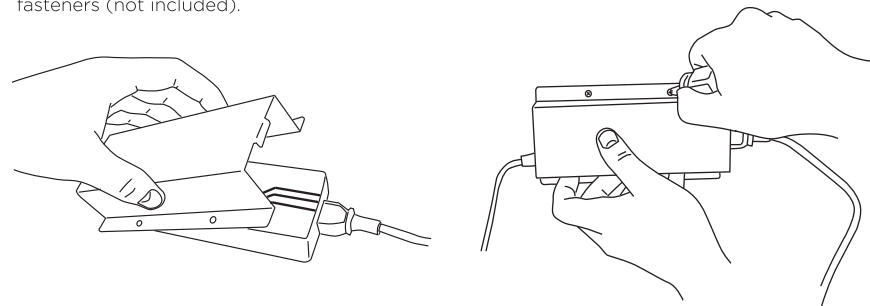
**5. SPLICE CABLE**

After determining the correct length and wire gauge needed, butt splice your wire to the pigtails using a wire crimping tool. NOTE - A male pigtail is not included with the CE-PS90 power supply, however it may be included with your monitor.

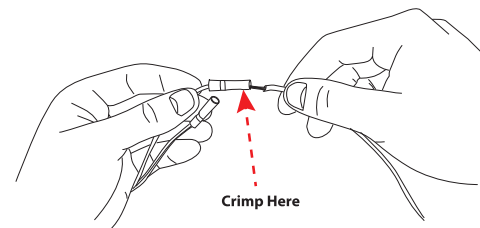
**6. MAKE POWER CONNECTIONS**

Plug the included female pigtail into the male end of the AC adapter's plug.

Plug the male pigtail into the 24VDC power input located on the back of your device.

Plug the AC power cord into the wall outlet, and turn on your monitor.

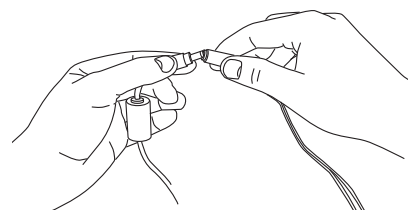

FEMALE PIGTAIL - INCLUDED WITH CE-PS90

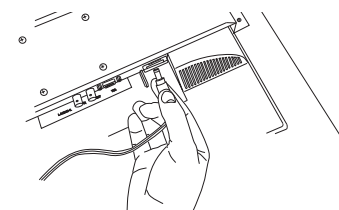

MALE PIGTAIL - NOT INCLUDED WITH CE-PS90
(MAY BE INCLUDED WITH MONITOR)