

CE-EX360 Install Guide

v.03.07.19

Included Items:

- 360° Dome Camera x 1
- Phillips Screws x 4
- Drywall Anchors x 4
- 3mm Allen Wrench x 1

Required Items:

- Phillips Head Screwdriver
- DC12V (1 Amp) Power Supply
- 1" Drill Bit, Spade Bit or Hole Saw

Optional Items:

- CE-PTZKEYB: PTZ Keyboard

1. PREPARE MOUNTING SURFACE - (Surface Mount)

If "pendant mounting" with 1/4"-20 threaded hole skip to step 4b. Apply the supplied mounting template (see last page of this document) to the mounting surface. If the camera is mounted to a wall it is recommended to position the large hole towards the "right" (the image will be rotated if installed in any other configuration). Drill a hole in the surface for the cable and connections to pass through.

If mounting to a wall, position the template with the large hole at the right. Doing so ensures the image will not be rotated.

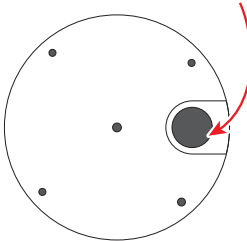

Normal Image

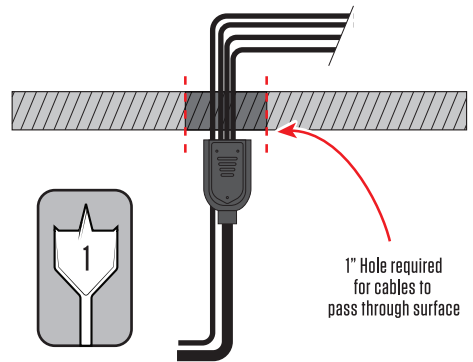

1" Hole required for cables to pass through surface



2. ATTACH CABLES

Make connections to the BNC cable (BLACK & SILVER for EX-SDI 2.0) and the power connection. **Use 12 Volt DC only for camera power!** Connect RS485 and Analog outputs as needed. Feed any cable slack into the mounting surface. To ensure quality operation, verify proper BNC and power termination, along with proper voltage at camera.

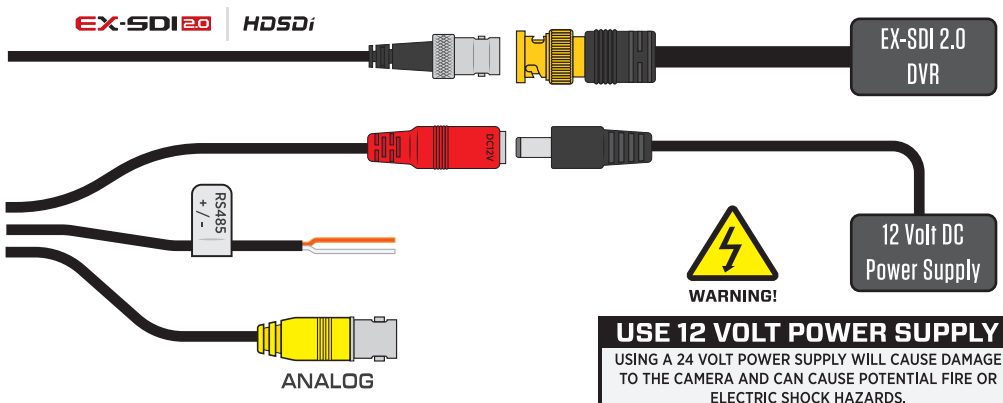

3. REMOVE DOME COVER

Use the supplied 3mm Allen Wrench to loosen the screws that hold the dome cover onto the base. Carefully separate the top dome cover from the camera base. The dome cover will not come completely off, it will be suspended by the safety cable and IR LED wires.

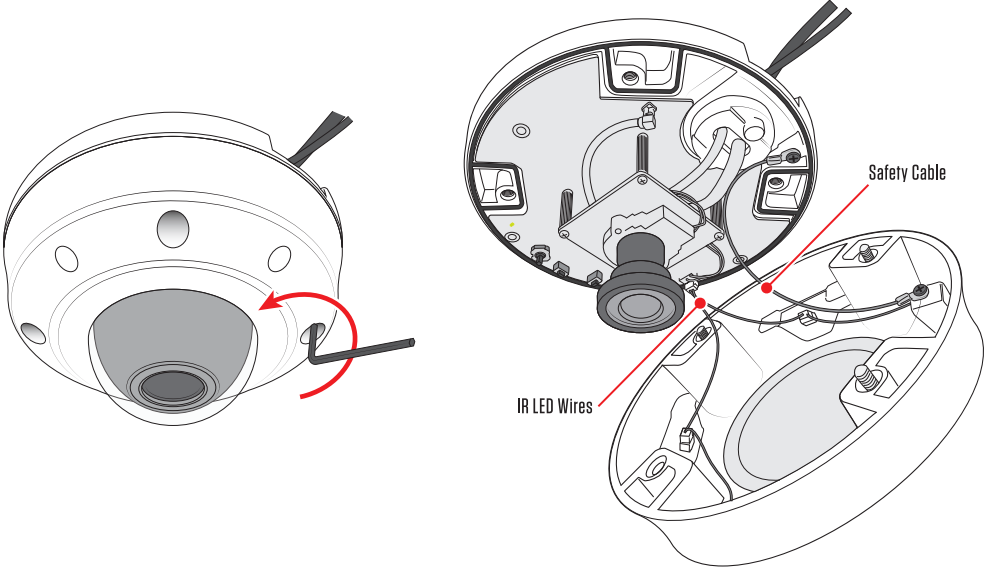

4a. INSTALL CAMERA - (Surface Mount)

If installing the mounting plate on solid surface such as wood use the 4 included Phillips-head screws. When installing onto drywall use the 4 included drywall anchors in conjunction with the screws.

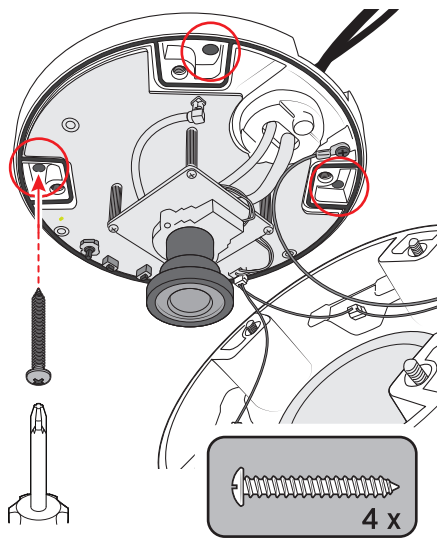

4b. INSTALL CAMERA - (1/4"-20 Mount)

Thread 1/4" - 20 bolt from mounting bracket into the center hole on the camera base.

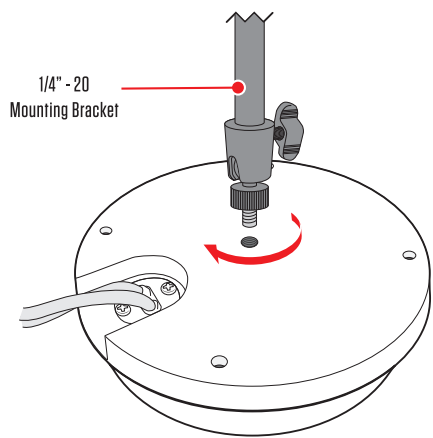

*Mounting bracket shown not included - Sold separately

5. OSD ADJUSTMENT / VIEW MODES

Before finalizing the installation and replacing the dome cover you may wish to adjust camera settings or change the view mode of the camera. To access the camera's OSD menu press 'IN' on the OSD Joystick. Press the View Mode button to cycle through different view modes of the camera. If for some reason the camera is not functioning correctly press the RESET button.

Camera settings and View Mode changes can also be made using RS485 keyboard. (see OSD/View Mode section of this manual)

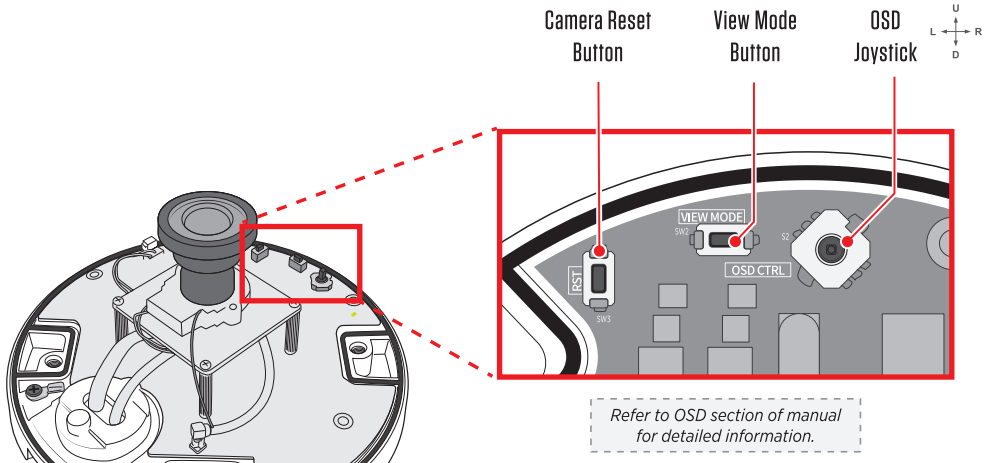

6. REPLACE DOME COVER

Use the supplied 3mm Allen Wrench to tighten the screws that hold the dome cover onto the base. When replacing the dome cover ensure the O-ring gasket is seated in the groove on the camera base. If this O-ring is not properly seated water and dust could enter the camera housing causing damage to the camera. Also, ensure the wires for the IR LEDs do not get pinched when replacing the cover. If these wires get pinched they could short— causing the IR LEDs to not function correctly.

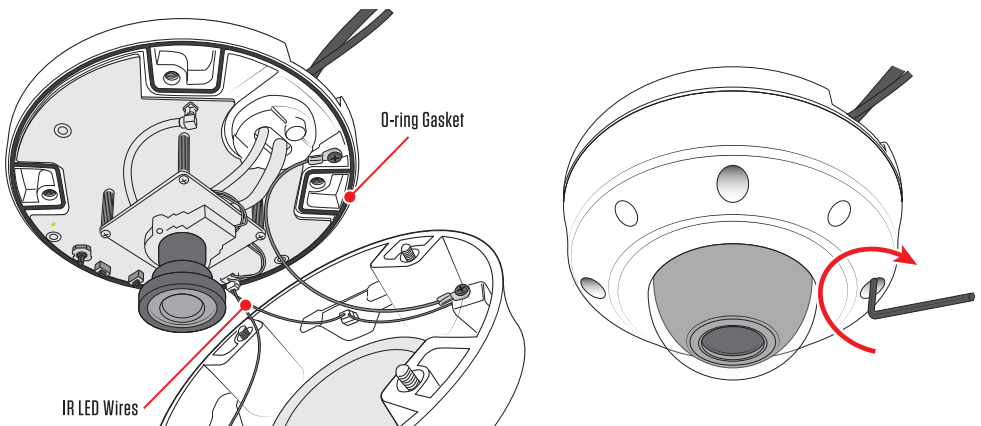

ENSURE THE WIRES FOR THE IR LEDS DO NOT GET PINCHED WHEN REPLACING THE COVER. IF THESE WIRES GET PINCHED THEY COULD SHORT— CAUSING THE IR LEDS TO NOT FUNCTION CORRECTLY.

CE-EX360 OSD/View Modes

ACCESSING THE OSD MENU - (RS485 Connection)

The OSD Menu can be accessed and View Modes can be changed either by using the built-in Joystick/buttons located on the camera board or with a PTZ keyboard via RS485 connection. When the camera is connected to a PTZ keyboard the Protocol must be set to Pelco D, and the Baudrate must be set to 9600. When properly setup, the camera can digitally perform pan, tilt and zoom operations- depending on the view mode.

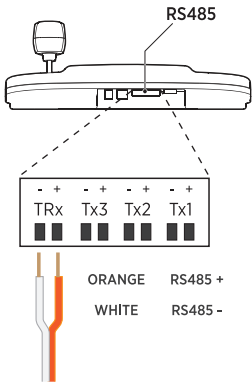

PROTOCOL	BAUDRATE
Pelco D	9600



WDS PEL-D 9.6
ID: 001

The Baudrate and Camera ID can be adjusted in the OSD Menu.

*CE-PTZKEYB shown - refer to PTZ Keyboard manual on how to edit keyboard settings.

PTZ KEYBOARD (CE-PTZKEYB) - Control Layout

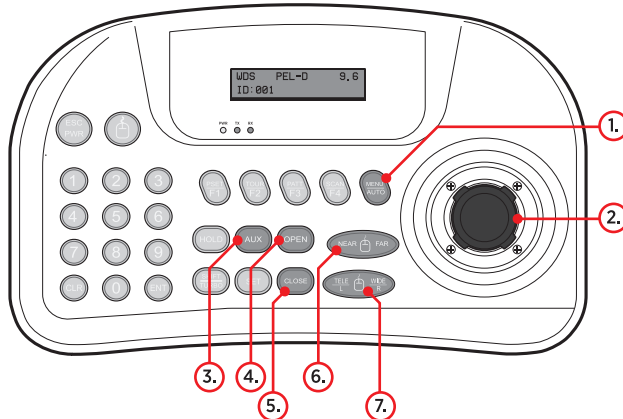

- 1. MENU/AUTO:** Enters OSD Menu, press to "SET" or ENTER a menu option
- 2. JOYSTICK:** Directional movement in OSD menu and "digital PTZ" control
- 3. AUX:** Change View Modes
- 4. OPEN:** Press to adjust camera position/zoom and cycle through Ch1-Ch4
- 5. CLOSE:** Exits "digital PTZ" mode
- 6. NEAR/FAR:** Rotates the image in 4ch View Mode
- 7. TELE/WIDE:** Zoom In/Out in 4ch View Mode

OSD MENU SETTINGS

After pressing either the joystick 'IN' on the camera board or the MENU/AUTO button on the PTZ Keyboard the OSD Menu will display on the connected monitor. Navigate the menu by moving the joystick Up or Down and adjust options by moving the joystick Left or Right.

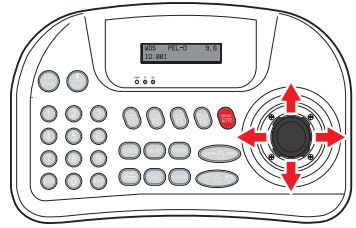

MENU/AUTO

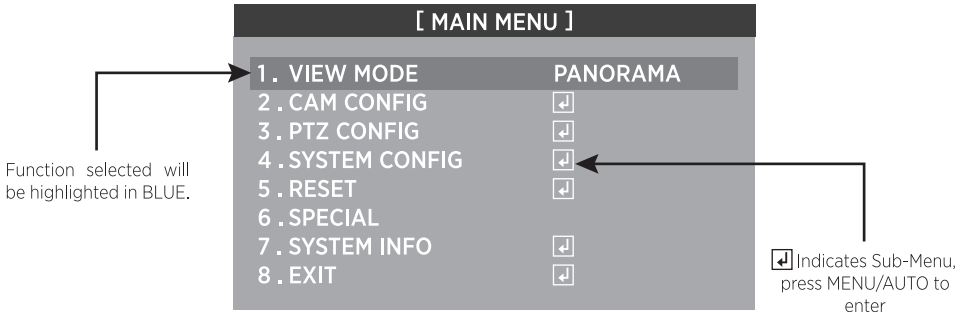

The OSD Menu does not time-out, it will remain on the screen until EXIT is selected.

PTZ CONTROL

When set to 4CH View Mode: To change the position of an individual channel press the OPEN button on the PTZ Keyboard. The selected channel will be display in the center of the screen.

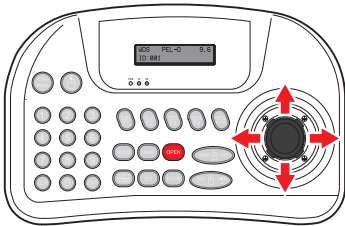

OPEN

PTZ Control for Channel 1

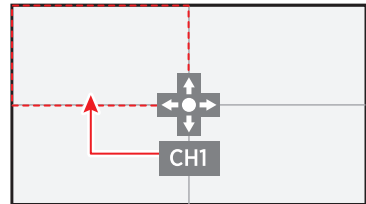

Adjust the position using the joystick to pan, tilt or zoom the image to the selected area.

If the image needs to be rotated use the NEAR/FAR button.

Press the OPEN button again to selected another channel to adjust.

Press the CLOSE button to exit PTZ adjustment.

Pan, tilt, zoom functions will vary depending on the selected View Mode.

VIEW MODE

Move the joystick Left or Right to cycle through the different View Modes.

ORIGINAL



PANORAMA

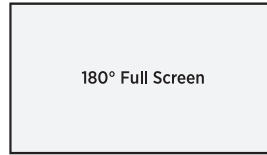

4CH

Ch 1	Ch 2
Ch 3	Ch 4

1 ORG + 3CH

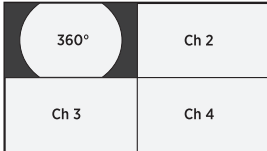

2CH CEILING

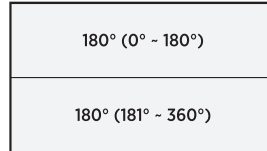

2CH TABLE

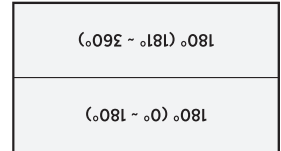

Select if camera is installed facing the floor.

Select if camera is installed facing the ceiling.



Pressing the **AUX** button on the PTZ Keyboard will also cycle through the different View Modes (when not in the OSD Menu).

CAM CONFIG

Select to configure advanced camera settings such as Exposure, Backlight, White Balance and other settings. Entering this set of options will change the View Mode to Original (360° Fisheye).

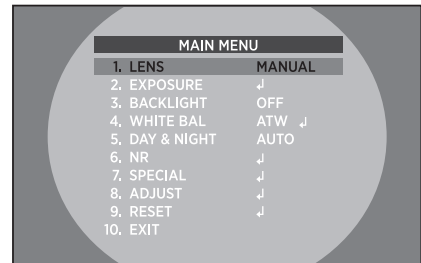
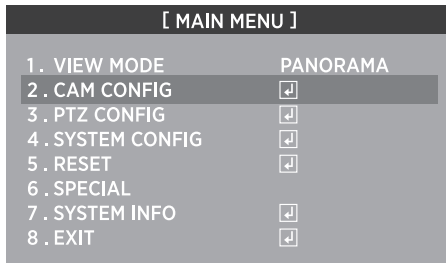

The View Mode will return to the previously selected mode after exiting the Camera Config Menu.

PTZ CONFIG

Select to configure Pan, Tilt and Zoom settings in the different View Modes (does not apply to Original View Mode).

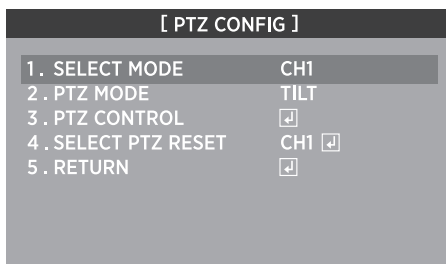

- 1. SELECT MODE:** Select the channel/display mode to adjust.
- 2. PTZ MODE:** Choose to adjust either Pan, Tilt or Zoom.
- 3. PTZ CONTROL:** Enter to adjust selected mode and ptz setting— use joystick to adjust value. Press Menu/Auto to exit.
- 4. SELECT PTZ RESET:** Factory resets the selected view mode/channel.
- 5. RETURN:** Exits PTZ Config menu.

SYSTEM CONFIG

Configure main systems settings such as assigning a Camera ID and Baudrate values.

[SYSTEM CONFIG]	
1. CAM ID	GROUP 1
2. BAUDRATE	9600
3. FRAME RATE	1080P30
4. CVBS FORMAT	NTSC
5. SDI FORMAT	EX-SDI V2
6. SAVE	NO <input type="checkbox"/>
7. RETURN	<input type="checkbox"/>

- 1. CAM ID:** Selectable from 1-255.
- 2. BAUDRATE:** Set baudrate; 2.4K, 4.8K, 9.6K, 19.2K, 38.4K, 57.6K
- 3. FRAME RATE:** Adjust frame rate; 1080p25, 1080p30, 1080p60. Setting to 1080p60 will not display on most DVRs (no video).
- 4. CVBS FORMAT:** Select either NTSC or PAL analog video format.
- 5. SDI FORMAT:** EX-SDI V2 (2.0), EX-SDI V1 (1.0), HD-SDI
- 6. SAVE:** Select YES to save current changes. Selecting YES will power cycle the camera. If baudrate or ID changes were made in the camera they will need to be edited on the PTZ Keyboard.

Ensure connected device(s) can accept selected frame rate, CVBS and SDI format.

RESET

Select to reset all camera settings to factory defaults.

[RESET]	
1. FACTORY RESET	YES <input type="checkbox"/>
2. RETURN	<input type="checkbox"/>

- 1. FACTORY RESET:** Select YES then press Menu/Auto to reset the camera. This will power cycle the camera, any changed baudrate, cam ID or other settings will be erased.

SPECIAL

No user selectable function.

SYSTEM INFO

View current camera settings.

[SYSTEM INFO]	
<input type="checkbox"/> F/W VERSION	V718090E
<input type="checkbox"/> BAUD RATE	9600
<input type="checkbox"/> RESOLUTION	1080P30
<input type="checkbox"/> CVBS FORMAT	NTSC
<input type="checkbox"/> SDI FORMAT	EX-SDI V2
<input type="checkbox"/> LANGUAGE	ENGLISH
<input type="checkbox"/> RETURN	<input type="checkbox"/>

EXIT

Exits the OSD Menu.

CE-EX360 Mounting Template

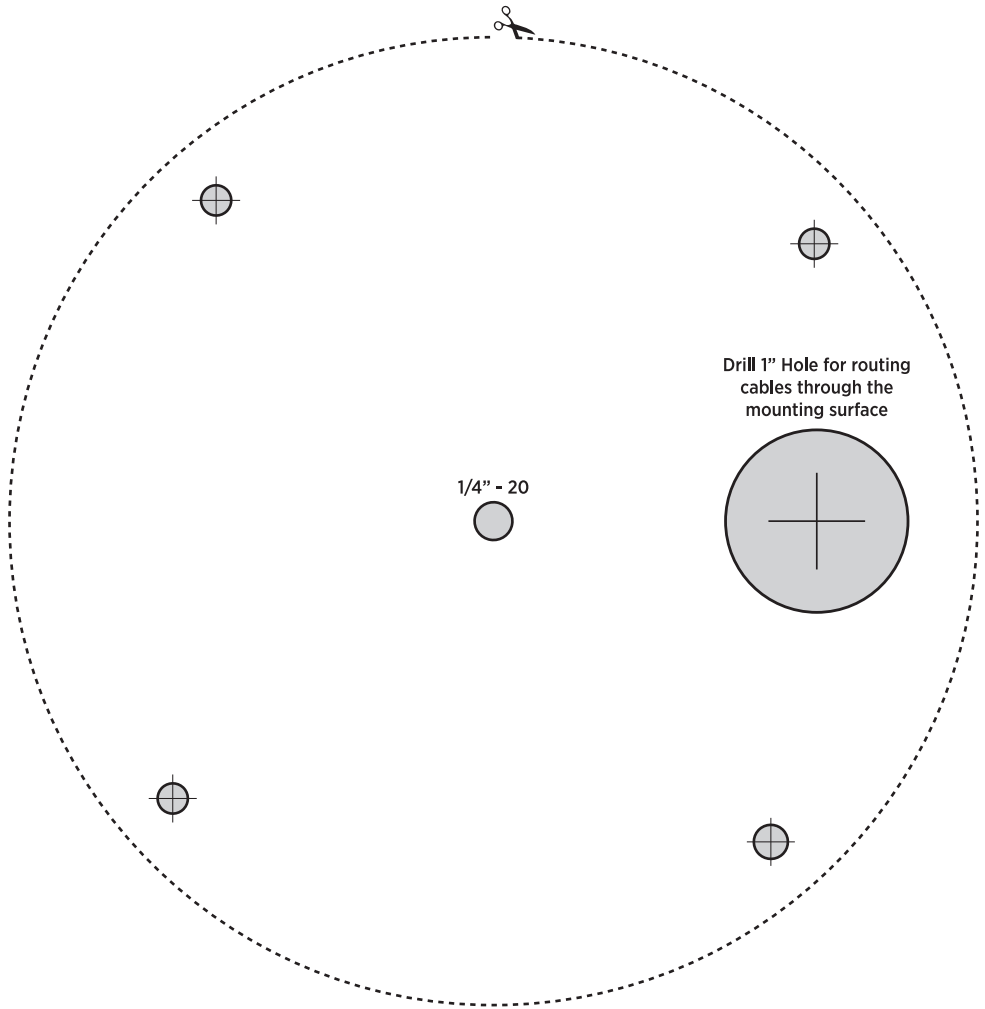

Drill 1" Hole for routing cables through the mounting surface

1/4" - 20

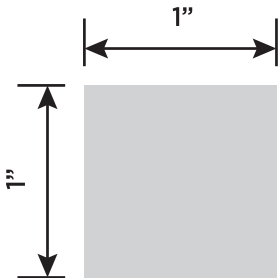

IMPORTANT: Scale 1:1

If printing this document set the printer to print at 100% with no document scaling (do not set to "Fit to Page").

Measure the 1" box at the left to confirm it has printed to scale.

v.04.22.19

Clinton Electronics reserves the right, without notification to make changes in product design & specification.