

# 13" Connect PVM Basic Setup Guide

## 1. Remove Cover Plate and Install PVM

Remove the cover plate on the back-side of the PVM and set aside. Install the PVM to desired VESA mount following instructions supplied with VESA mount.

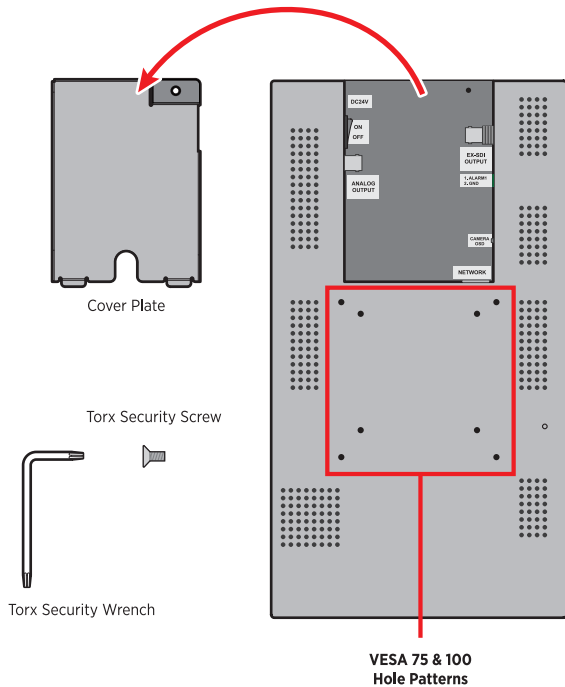

## 2. Connect Power

Connect barrel plug-end from DC24V power supply to the PVM (or use supplied pigtail adapter cable).

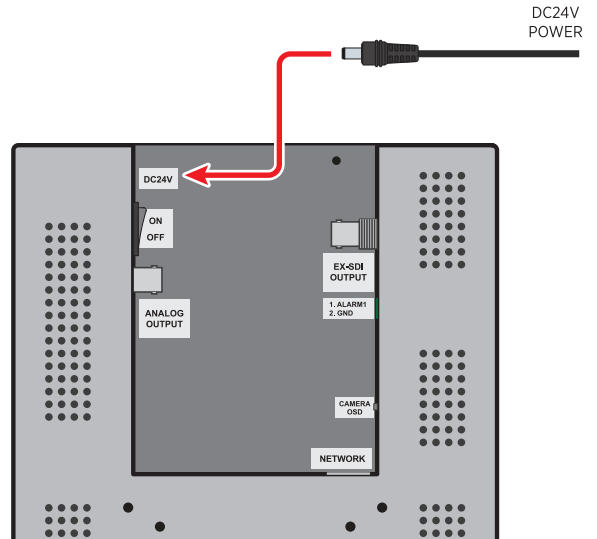

*\*Replace Cover and Security Screw when setup is complete.*

## 3. Connect Network

Connect an ethernet cable to the port marked 'NETWORK' if this PVM will use a "hard-wired" network connection. Skip this step if the this PVM will connect via WiFi.

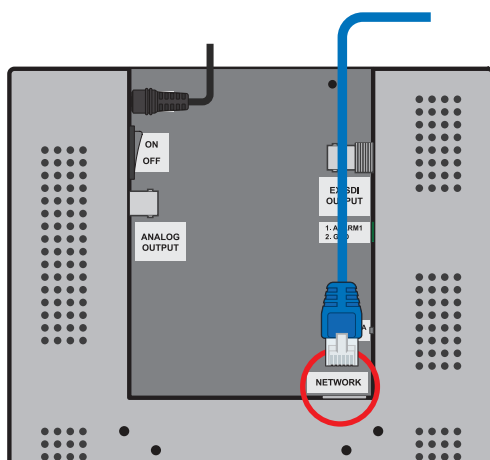

**This is NOT a PoE device!**  
Power must come from DC24V source

## 4. Power 'ON' PVM and Begin On-Screen Setup

Set the power switch to the ON position. Wait for the boot-up to complete.

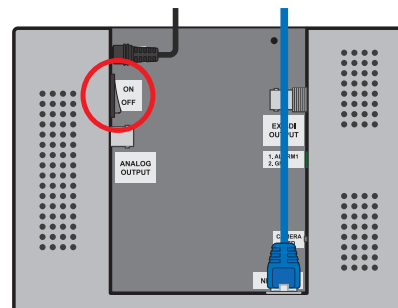

Start of Boot-up

.....

Boot-up Complete

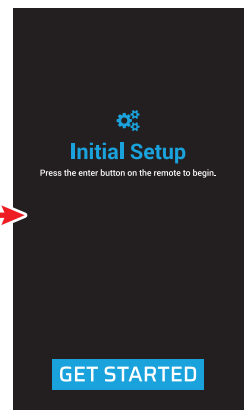

*\*A network connection is required for the PVM to receive media updates and complete the setup process.*

### 5. Connect to Internet

Follow the on-screen prompts using the included remote and connect to the desired network. After selecting a network (and entering a password if applicable), an Internet check test will be performed.

Remote is required for setup



Keep the remote in a safe place for later use

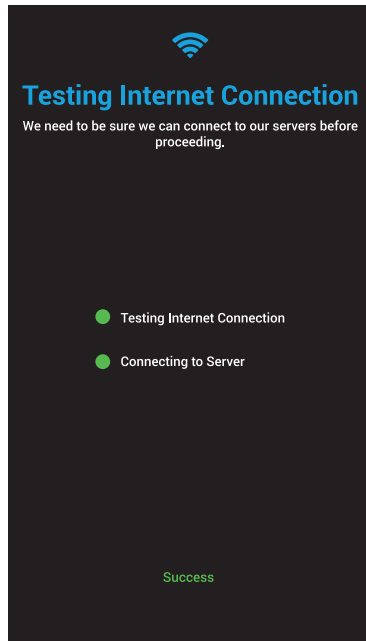

*\*If the device can not connect to the internet and/or the Clinton server— contact the company's IT admin.*

### 6. Scan QR Code and Complete Setup

Display the company-specific QR Code when prompted. Ensure the correct company code is being used, using the wrong company code will result in the PVM receiving incorrect updates.



*\*The QR Code is required to associate the PVM with a company so it can receive the correct content. If you do not have a QR Code, contact your supervisor or Clinton Connect account admin and to request a code. The QR Code can be found online at [app.clintonconnect.com](http://app.clintonconnect.com)*

### 13" EX-SDI PVMs: Optional Connections

If desired, connect alarm input connections using the included 2-Pin terminal block.

If connecting locally to a DVR; use either the Analog or EX-SDI Output.

The EX-SDI camera settings can be adjusted using the OSD Joystick located near the Network connection.

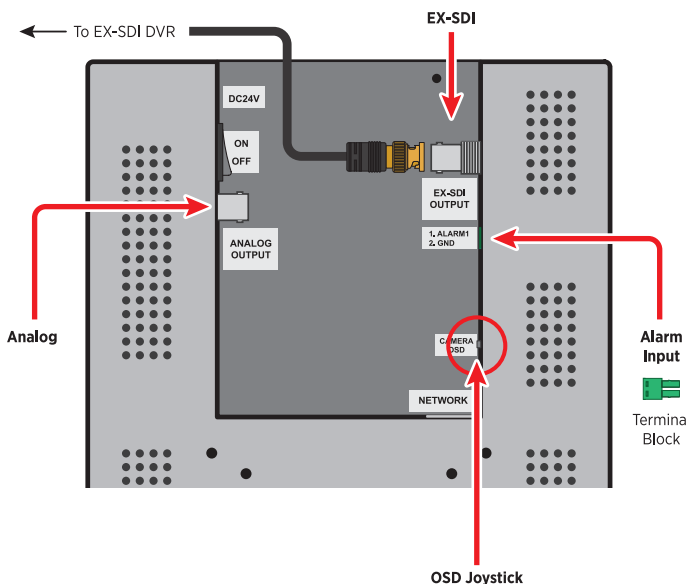

### 13" IP PVMs: Optional Connections

If desired, connect alarm input connections using the included 2-Pin terminal block.

The IP camera uses its own network connection (it can not be accessed using the network connection used in Step 4). To view the IP camera on the network connect a separate ethernet connection to the port marked IP Camera and follow the setup instructions from the included IP camera software.

