

# CE-CPUP(B) Install Guide

## Included Items:

- CE-CPUP Universal Mount Assembly
- CE-CPUP to Pole Mounting Hardware
- Instructions

## Not Included:

- Screws & Nuts for mounting camera or access point to plate

## Required Items:

- Two 7/16" Wrenches

## Optional Items:

- Sheet Metal Shears
- Phillips Head Screwdriver

**! Maximum Load Capacity: 10 lbs / 4.5 kgs !**



**CAUTION!**

## USE ONLY AS DESIGNED

THIS PRODUCT IS DESIGNED TO SERVE AS A MOUNTING APPARATUS BETWEEN A CAMERA POLE MOUNT AND A CAMERA, WIRELESS ACCESS POINT, OR OTHER SMALL LOW VOLTAGE DEVICE. REFER TO THE CAMERA POLE INSTALLATION GUIDE FOR DETAILS ON INSTALLING THE CAMERA POLE. IT IS INTENDED FOR USE ONLY WITH THE MAXIMUM WEIGHT INDICATED. USE WITH PRODUCTS HEAVIER THAN THE MAXIMUM WEIGHTS INDICATED MAY RESULT IN INSTABILITY CAUSING POSSIBLE INJURY.

### 1. ALIGN DEVICE

Align the mounting holes on your device to at least 2 slots in the plate.

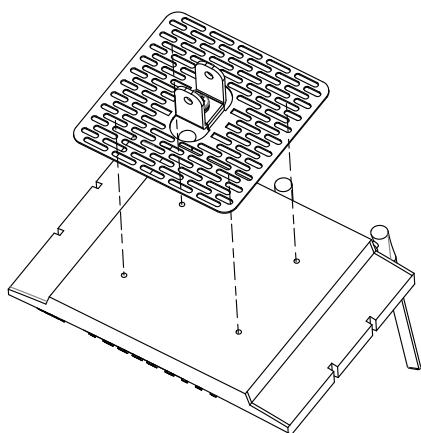

### OPTIONAL : TRIM PLATE SIZE

If the plate overhangs your device, you can choose to trim the plate to the desired size using sheet metal shears.

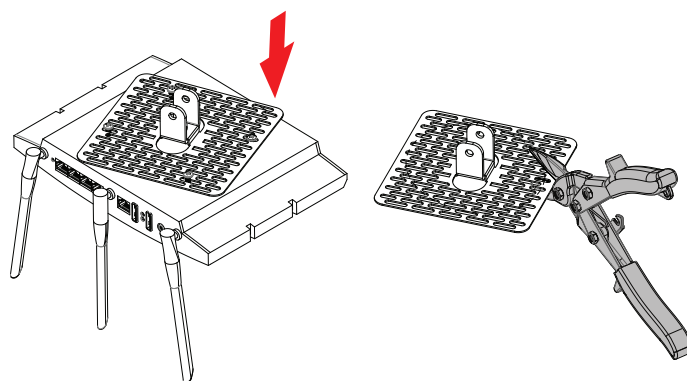

### 2. ATTACH PLATE

Attach your device to the plate with machine screws and nuts (NOT INCLUDED).

Plate will allow for use of common sized #10-24, #10-32, #8-32, M4, or smaller diameter machine screw sizes. If necessary, use washers between the plate and attached device for routing cables between the plate and device.

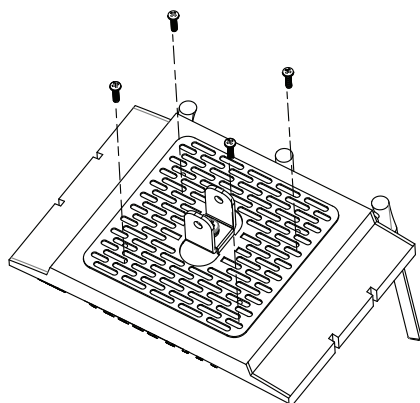

### 3. CONNECT CABLES & MOUNT

Attach device cables to their supply, and feed any slack into the pole. Using the two 7/16" wrenches, secure the CE-CPUP bracket to the pole using the included 1/4-20 bolt, washer, lock washer, and lock nut.

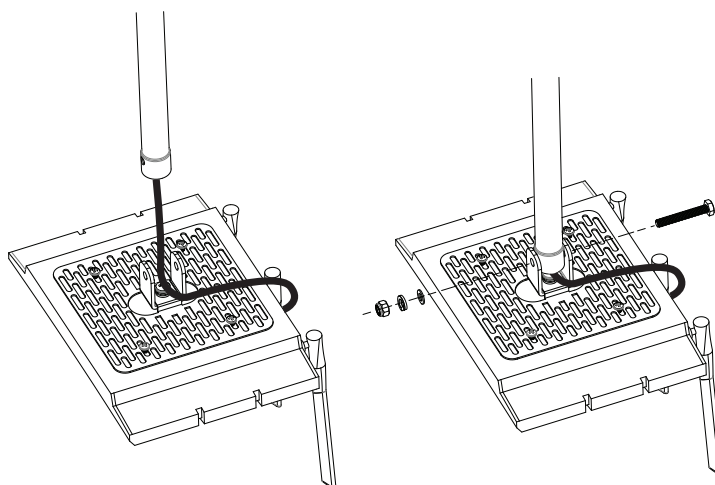

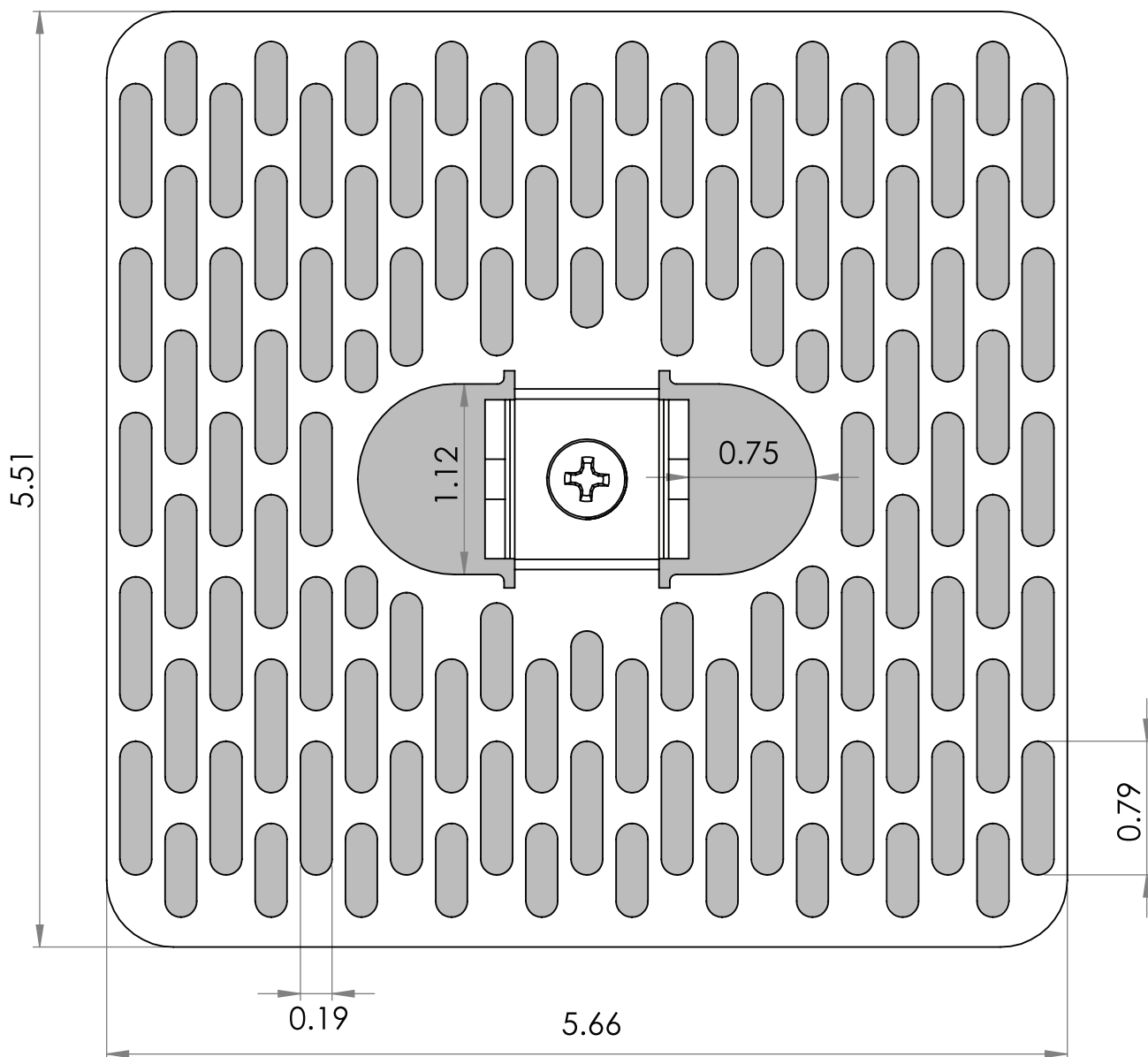
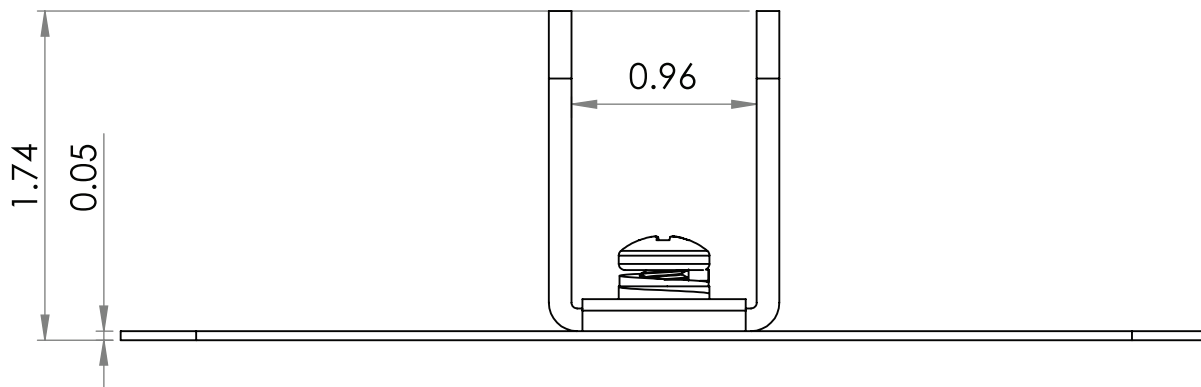

SCALE 1 : 1

**IMPORTANT!**

When using this document to confirm equipment alignment, set printer to print at 100%, with no document scaling. Measure the 1" mark below to confirm it has printed full scale.

