

CE-M5 Install Guide

Included Items:

- Mounting Pole
- Mounting Hardware
- VESA Mounting Bracket
- Right Angle Bracket
- Instructions

Required Items:

- 3/16" Allen Wrench
- 5/16" Nut Driver
- 7/16" Wrench
- 10mm Wrench
- Phillips Head Screwdriver



Maximum Load Capacity: 8 lbs / 3.6 kgs



CAUTION!

USE ONLY AS DESIGNED

THIS MOUNT IS DESIGNED TO ATTACH A MONITOR OR PVM TO A FREESTANDING STEEL SHELF UPRIGHT, METAL PIPE OR TUBE, OR STRUT CHANNEL STRUCTURE. IT IS NOT DESIGNED TO MOUNT TO A WOODEN SURFACE. IT IS INTENDED FOR USE ONLY WITH THE MAXIMUM WEIGHT INDICATED. USE WITH PRODUCTS HEAVIER THAN THE MAXIMUM WEIGHTS INDICATED MAY RESULT IN INSTABILITY CAUSING POSSIBLE INJURY.

1a. ATTACH MOUNTING PLATE - VERTICAL MOUNTING

The M5 bracket is designed to mount to most freestanding steel shelving uprights. It can be mounted vertically with use of the right angle bracket, or horizontally (see step 1b.). Attach the angle bracket to the upright by feeding the two included 1/4"-20 x 3-1/2" bolts through slots in the steel shelving upright. Attach the 1/4" lock washer and locknut to the bolt and tighten using 10mm and 7/16" wrenches.

Attach the mounting plate to the angle bracket by securing the two included 1/4"-20 x 1/2" bolts to the best mounting holes for your orientation. Tighten using a 10mm wrench.

VERTICAL MOUNTING

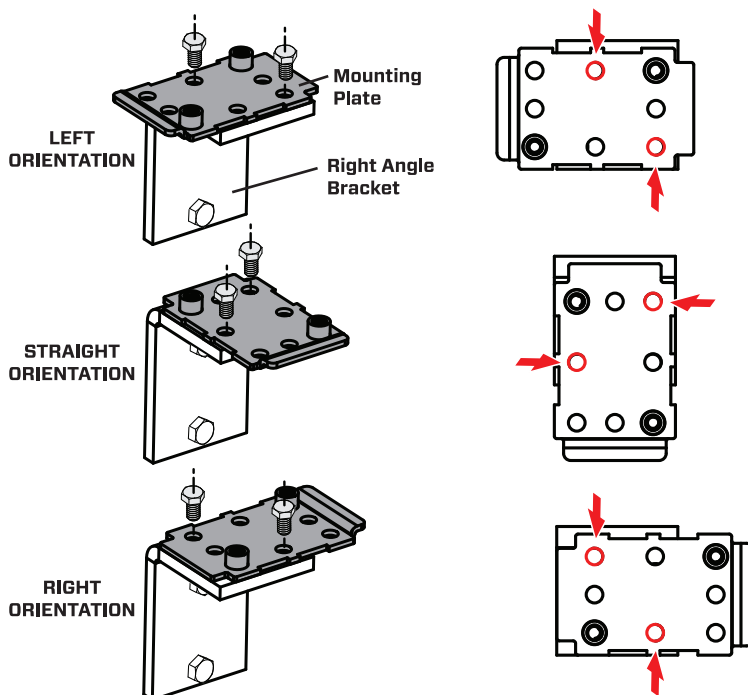
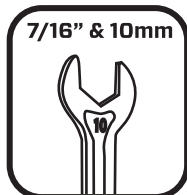
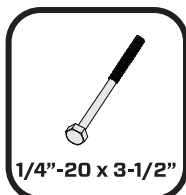
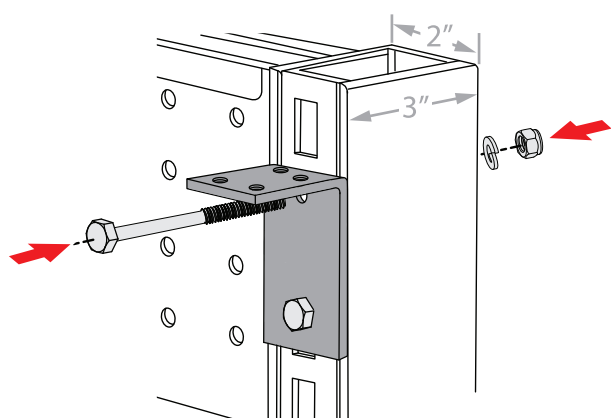

1b. ATTACH MOUNTING PLATE - HORIZONTAL MOUNTING

Attach the mounting plate to the upright by feeding the two included 1/4"-20 x 3-1/2" bolts through slots in the steel shelving upright. Attach the 1/4" lock washer and locknut to the bolt and tighten using 10mm and 7/16" wrenches.

Whenever possible, the hook side of the plate should face upward to aide in installation.

HORIZONTAL MOUNTING

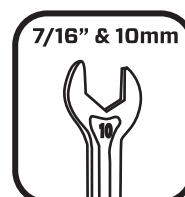
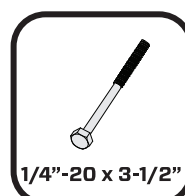
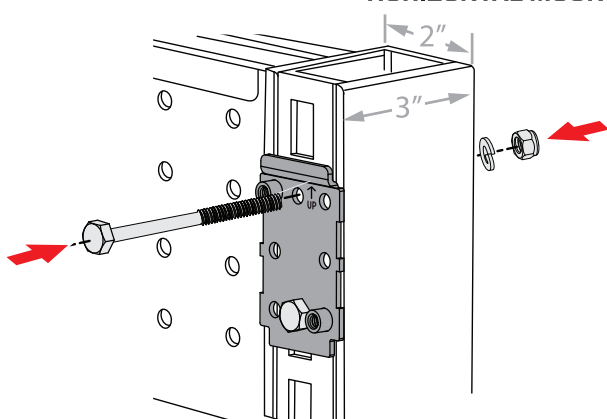

2. ATTACH VESA BRACKET & CRUSH SUPPORT TO POLE

Slide the crush support piece into the end of the pole. Attach the VESA bracket to the end of the pole using the included 1/4"-20 x 1-1/2" bolt, 1/4" washer, lock washer, and locknut. Tighten with 10mm & 7/16" wrenches.

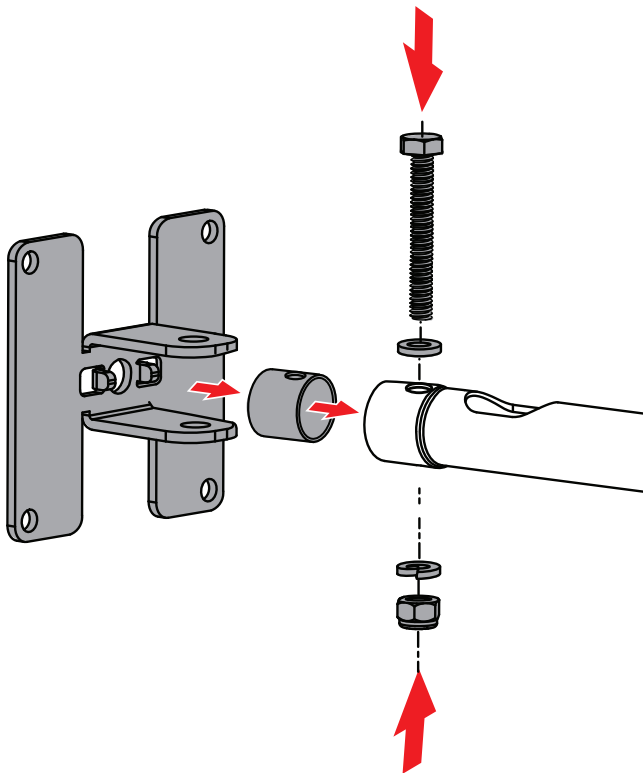

3. ATTACH MONITOR

Set the monitor/PVM face down on a clean, flat surface. Align the VESA 75 pattern to the mounting pattern on the monitor/PVM. Attach the mount to the monitor/PVM by tightening the included four M4 screws with a Phillips head screwdriver.

NOTE: Position the pole's slot in the desired direction for best cable routing.

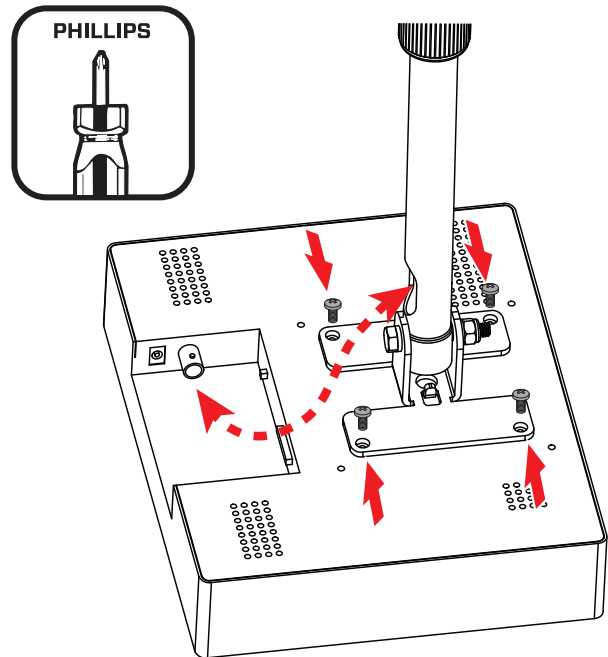

4a. ATTACH TO MOUNTING PLATE - M5 VERTICAL

Position the cable routing slot in the desired orientation for cable routing in the final step. Slide the bent tabs of the pole's base onto the support hook on the mounting plate.

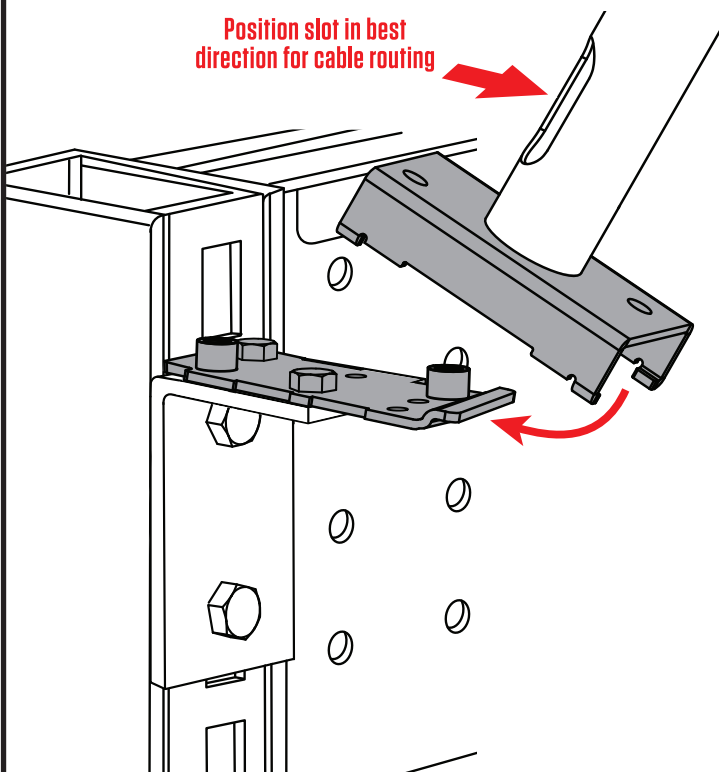

4b. ATTACH TO MOUNTING PLATE - M4 & M5 HORIZONTAL

Position the cable routing slot in the desired orientation for cable routing in the final step. Slide the bent tabs of the pole's base onto the support hook on the mounting plate.

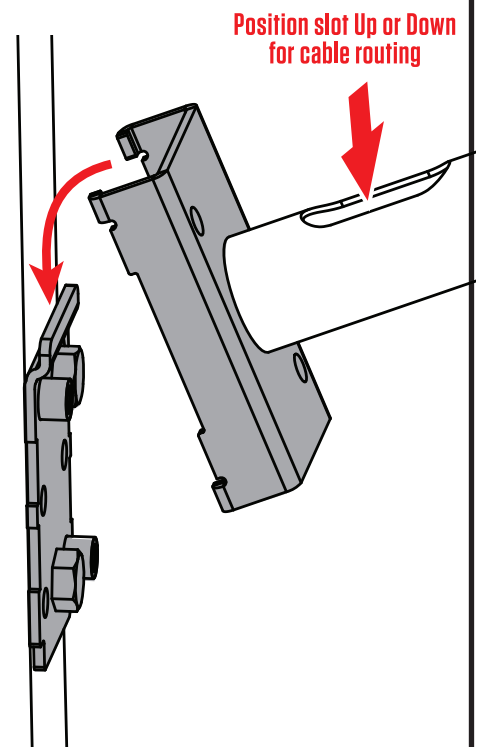

5. SECURE BASE

Secure the base to the mounting plate by tightening the included 1/4"-20 socket cap screws with a 3/16" Allen wrench.

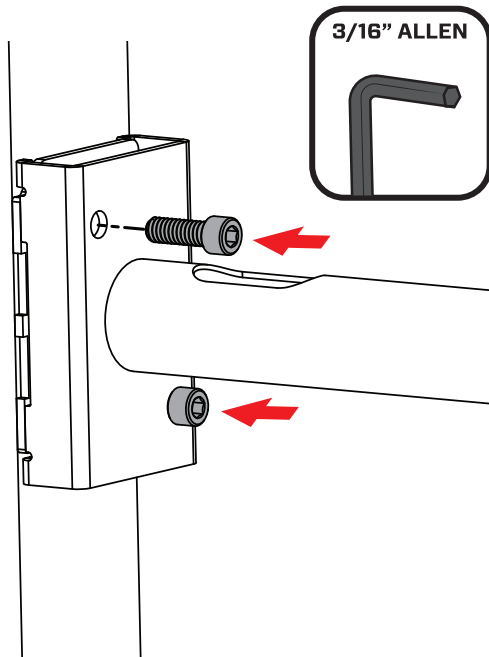

6. ADJUST POLE LENGTH

Loosen the twist-lock collar by turning it counter-clockwise. Extend the pole by gently pulling it out to the desired length.

Once the length of the pole has been adjusted, lock the pole in position by rotating the twist-lock collar clockwise as snug as possible.

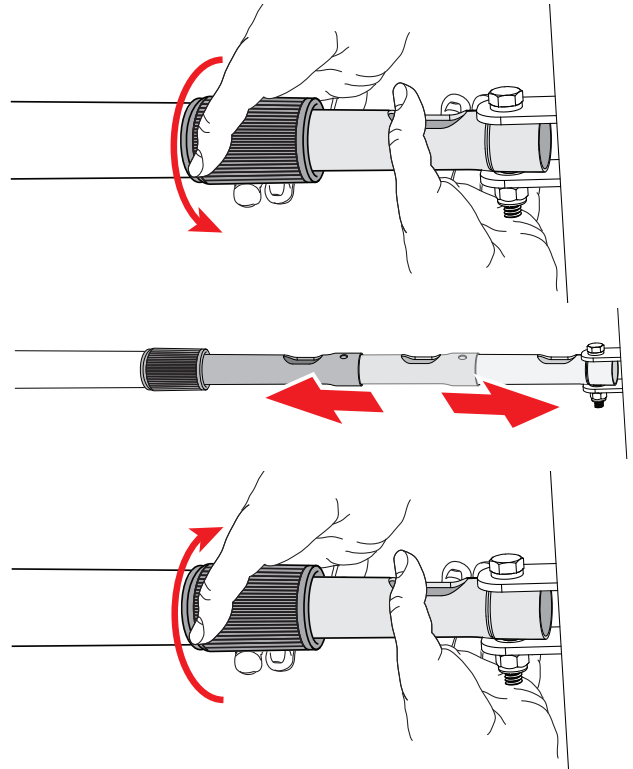

7. ROUTE CABLES

Feed the desired power and video cables through the slot near the base of the pole and out through the slot at the monitor/PVM end of the pole.

