

CE-HD2FO-TX1 User Guide

HD-SDI & RS485 to Fiber Transmitter

Use with an HD-SDI camera to transmit an HD-SDI signal (and RS485 data) up to 12 miles. Use in conjunction with the CE-HD2FO-RX1 Receiver (sold separately).

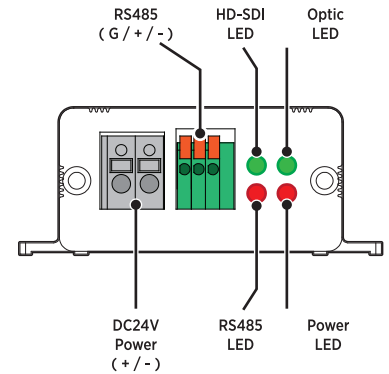
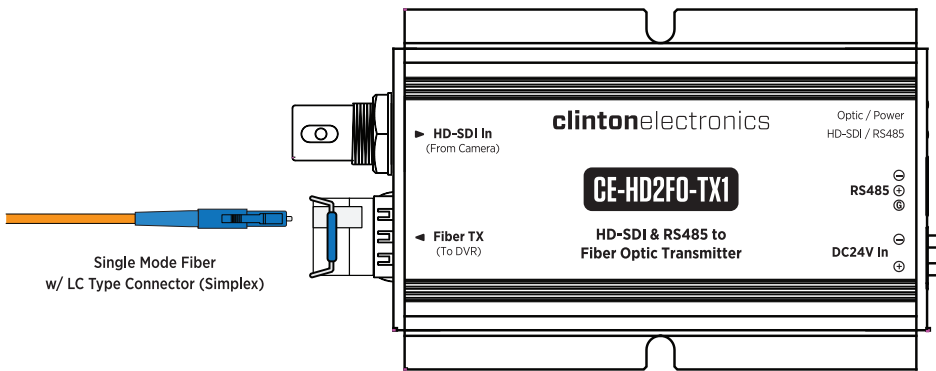

TRANSMITTER - (from the Camera side):

- Connect HD-SDI output from camera into the connection marked **HD-SDI In**.
 - limit HD-SDI run from camera to transmitter to no more than 275 ft (using RG59 coaxial cable)
 - excessively long runs of cable can cause video loss when using HD-SDI
- Connect RS485 wires (optional).
 - observe correct polarity, if backwards PTZ control will not be possible
- Connect Single Mode Fiber Optic cable with LC Type Connector (Simplex) into connection marked **Fiber TX**.
 - when making fiber connection insert connector fully until a 'CLICK' sound is made
 - after fully inserted pull the level to lock the fiber optical cable into the transmitter.
- Make power connections using DC24V power, ensure correct polarity is used.

**Power Supply Sold Separately*
- Check the status of the LED indicators to confirm the correct connections:
 - Optic: Green LED will be lit if good connection between TRANSMITTER & RECEIVER
 - Power: Red LED will be lit if power is on & correct polarity
 - HD-SDI: Green LED will be lit with good HD-SDI video signal
 - RS485: Red LED will blink when data is being transmitted/received
- Make connections to Receiver (CE-HD2FO-RX1), sold separately.

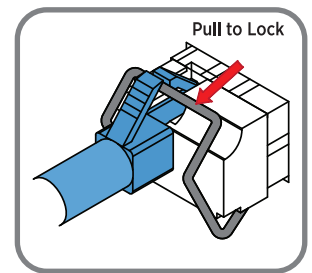

Fiber-Optic Cable Best Practices:

- At connection avoid tight bends.
- Don't pull cable from both ends.
- Don't spin the optical cable while connected to a device.
- Don't knot/kink the optical cable.

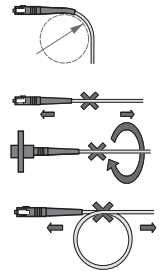

CONNECTION DIAGRAM

