

VX30/VX50 Install Guide

For Analog Vandal X Series Cameras: CE-VX30(B) • CE-VX50(B)

Included Items:

- Vandal X Series Dome Camera x 1
- Torx Wrench (T20 Security) x 1
- Instructions x 1
- Mounting Screws x 4
- Drywall Anchors x 4

Required Items:

- Phillips Head Screwdriver or Drill with Phillips Head Bit

Optional Items:

- CE-REMOTE (OSD Remote Control)

1a. DISASSEMBLE

Use the supplied Torx wrench to loosen the 3 Torx screws that hold the dome assembly onto the base. Remove the top dome cover from the camera base.

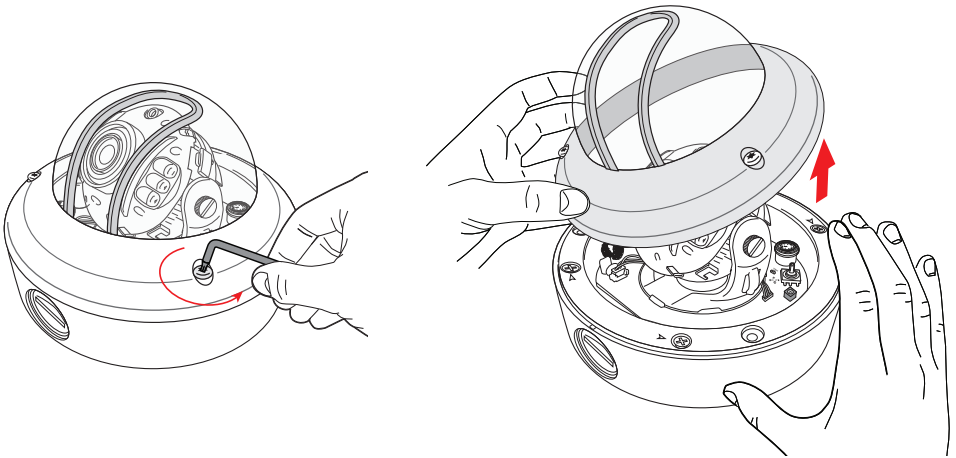

1b. DISASSEMBLE

Remove the four Phillips head screws that hold the inner case onto the camera base, then remove the inner camera assembly from the camera base. Keep these 4 screws for final assembly.

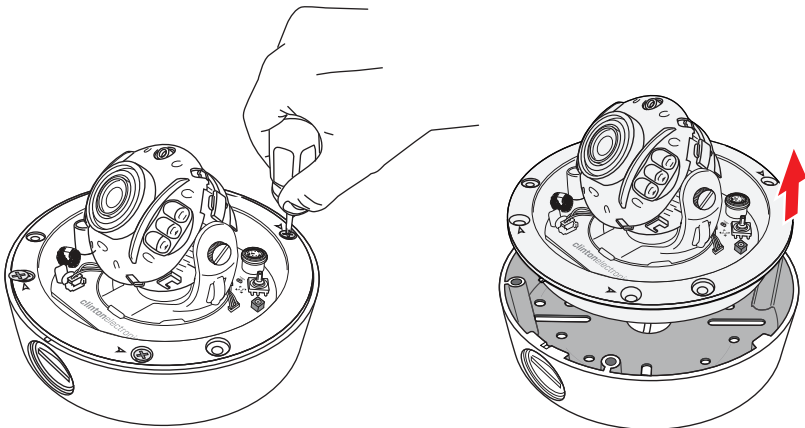

2. MOUNT OUTER CASE

If mounting to solid surface, use the four Phillips head mounting screws & drywall anchors if necessary.

If mounting to a conduit box, choose the mounting hole pattern that best suits your application and use the appropriate screws. Multiple mounting hole patterns are provided.

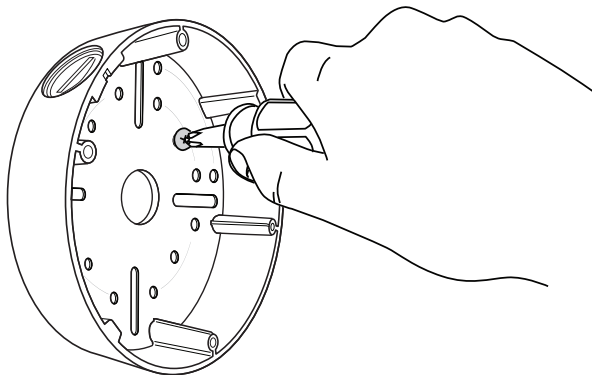

3. ATTACH CABLES

Feed the power and video cables through the desired access hole. There is a hole on the bottom of the case or a hole on the side. (using the side hole requires removing the slotted plug, replace plug from side to bottom).

Make connections to the BNC cable and the power connection. Feed any cable slack into the mounting surface. To ensure quality operation, verify proper BNC and power termination; along with proper voltage at camera.

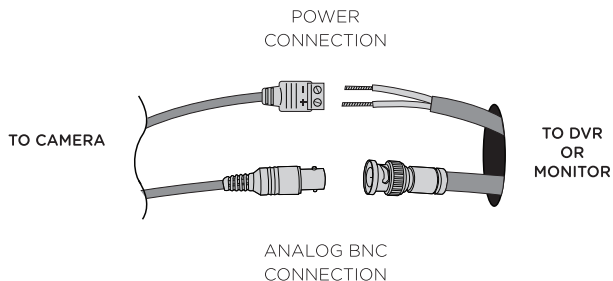

4a. ATTACH CAMERA

Replace the inner camera assembly into the mounting base as shown below.

Align the key on the lip of the inner camera assembly with the slot on the camera base when reassembling. If these are not aligned properly the weather resistant seal will be comprised, allowing water to leak into the camera.

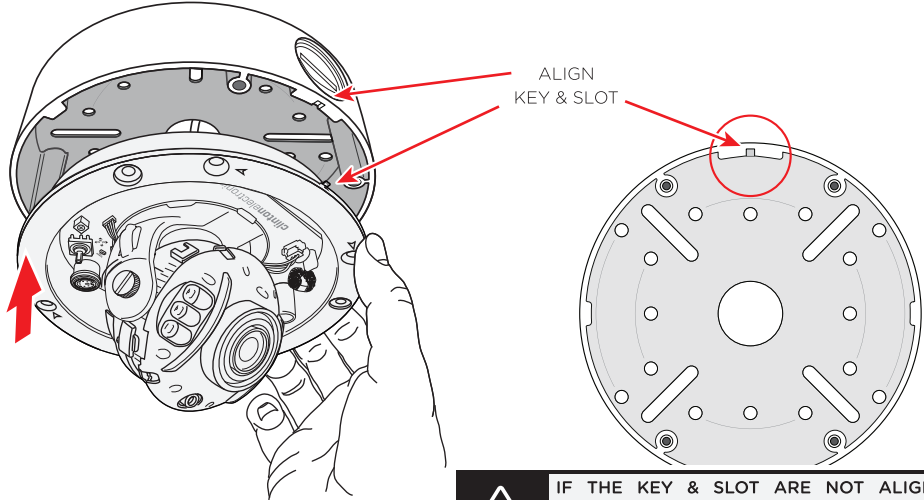



ATTENTION!

IF THE KEY & SLOT ARE NOT ALIGNED PROPERLY, THE WEATHER RESISTANT SEAL WILL BE COMPROMISED, ALLOWING WATER TO LEAK INTO THE CAMERA.

4b. ATTACH CAMERA

Replace the four Phillips head screws that hold the inner case to the camera base. The four holes are marked with arrowheads.

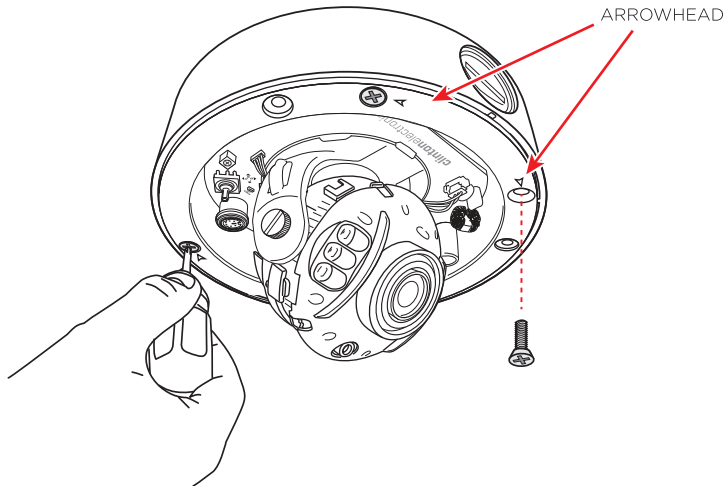

5. TEST MONITOR / OSD CONTROL

Before replacing the dome assembly you may wish to test the camera with a test monitor to verify proper camera angle/zoom/focus. To test; plug the CE-REMOTE into the DIN Port, and connect your test monitor to the Analog BNC connection located on the CE-REMOTE cable. Camera OSD Adjustment can be made by using the OSD Joystick or the optional CE-REMOTE.

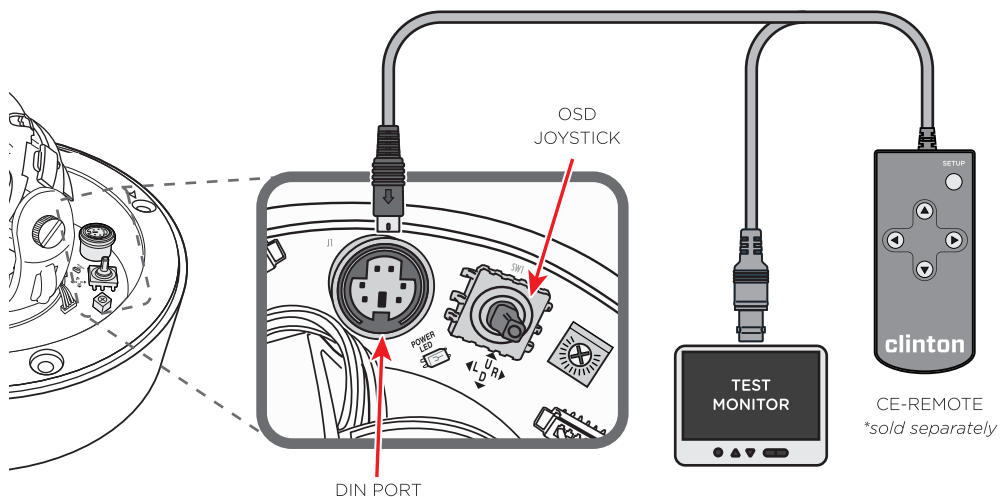

6. CAMERA ANGLE ADJUSTMENT

Adjust the angle of the camera as necessary.

- A. Lens Rotation:** Rotate the notched area on the camera assembly.
- B. Lens Angle:** Loosen thumb screws on each side to adjust the tilt of the lens.
- C. Camera Plate Rotation:** Pinch the gimbal U-Bracket and rotate the camera assembly on the base.

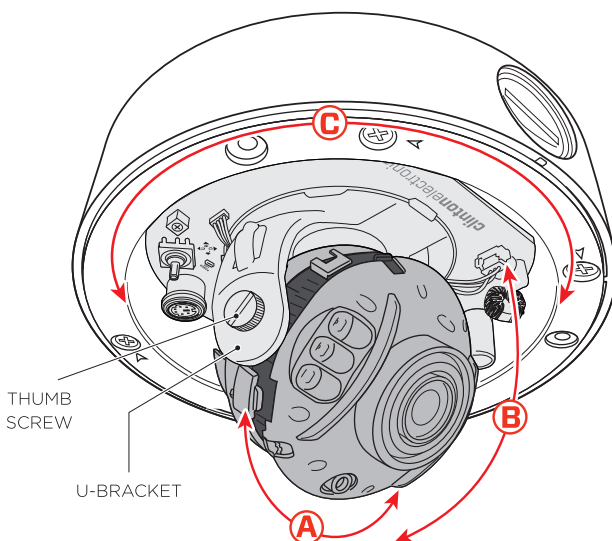

If the image is flipped; use the camera OSD adjustments to flip/mirror image.

7a. ZOOM / FOCUS ADJUSTMENT

The Zoom & Focus levers are located behind the IR cover plate. To access the levers, press the 2 tabs on either side of the cover. Lift the cover carefully away from the camera, taking care not to disconnect or damage the wires for the IR LEDs and IR Sensor.

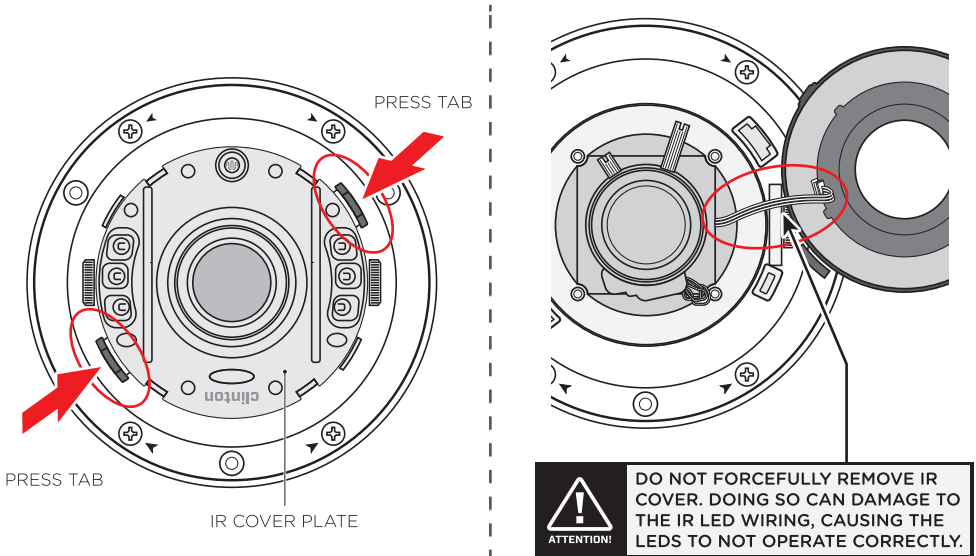

7b. ZOOM / FOCUS ADJUSTMENT

Loosen the appropriate adjustment lever by turning counter-clockwise. To widen or narrow the viewing angle rotate the ZOOM lever to the Left or Right. Rotate the Focus lever Left or Right to focus the lens.

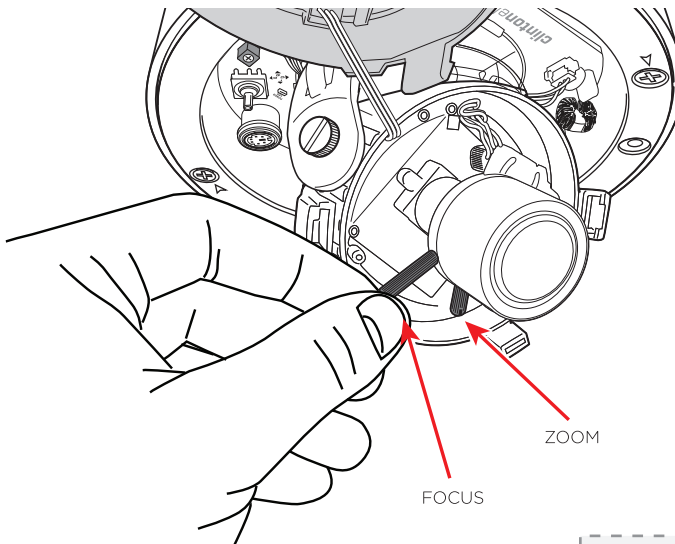

Tighten Zoom & Focus Levers when complete, then replace IR Cover.

8. IR LED ADJUSTMENT

Before replacing the dome cover it is recommended to test the operation and intensity of the IR LEDs. To test, cover the IR Sensor and verify that the IR LEDs turned 'ON'. To adjust the intensity of the IR LEDs, use a Phillips head screwdriver to turn the IR level adjustment potentiometer, (located next to the OSD Joystick on the board). Turn the screw to the LEFT (counter-clockwise) for brighter LEDs or to the RIGHT (clockwise) for dimmer LEDs.

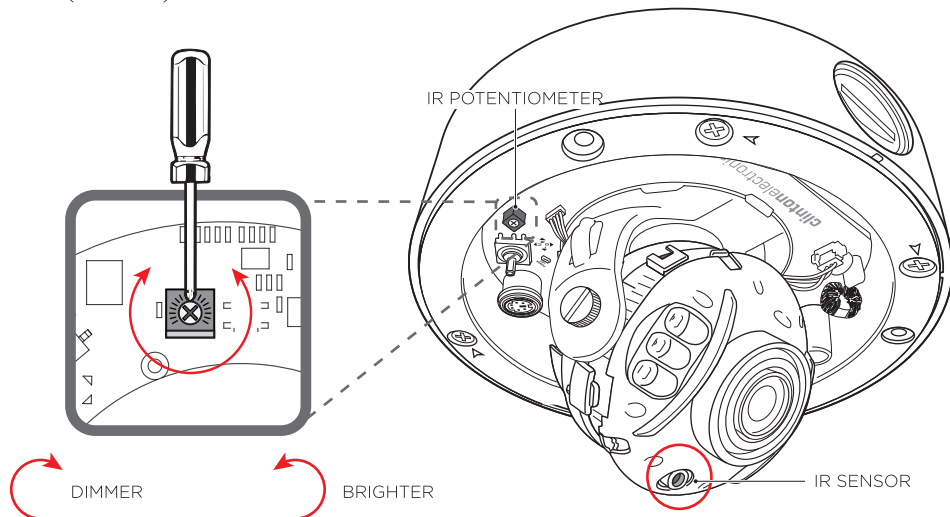

9. REASSEMBLE

Replace the dome cover onto the camera base. Align the IR Shield tracks with the guides on the camera assembly by turning the dome bubble. The cover must be loose, with no pressure applied, to turn the bubble. (it may be easier to turn the bubble with the cover removed).

Using the supplied Torx wrench, tighten the 3 Torx screws that hold the dome cover onto the base. Make sure each screw is tight to ensure superior weather resistance.

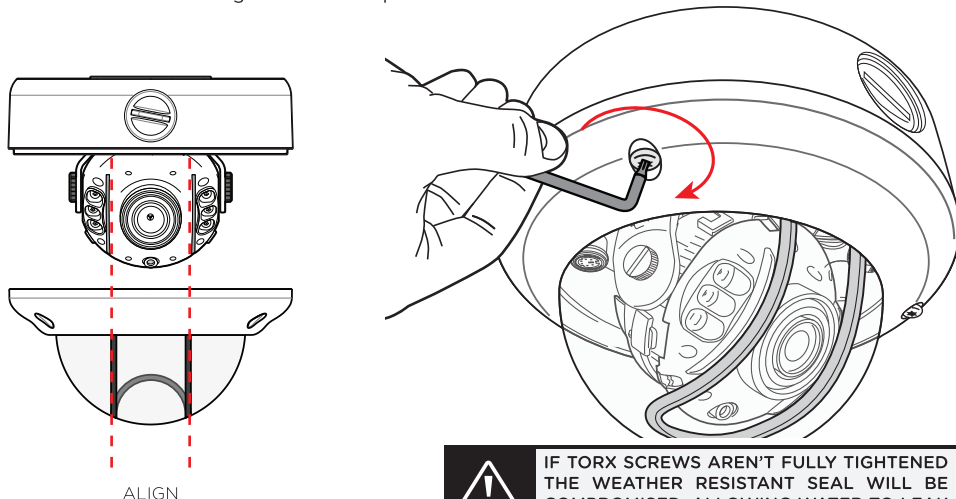

IF TORX SCREWS AREN'T FULLY TIGHTENED THE WEATHER RESISTANT SEAL WILL BE COMPROMISED, ALLOWING WATER TO LEAK INTO THE CAMERA.