

CE-LCD5.5

USER GUIDE

Included Items:

- Test Monitor x 1
- Monitor Bag x 1
- Battery Pack x 1
- Battery Charger x 1
- DC12V Power Supply x 1

- BNC to RCA adapter x 1
- Power/Video Adapter Cable x 1
- Shoulder/Neck Strap

Optional Items:

- BNC Jumper

1. CONNECT CABLES

Connect the cable from the monitor to the power/video adapter cable. Align the arrows on the connection ends to ensure proper connection of the pins.

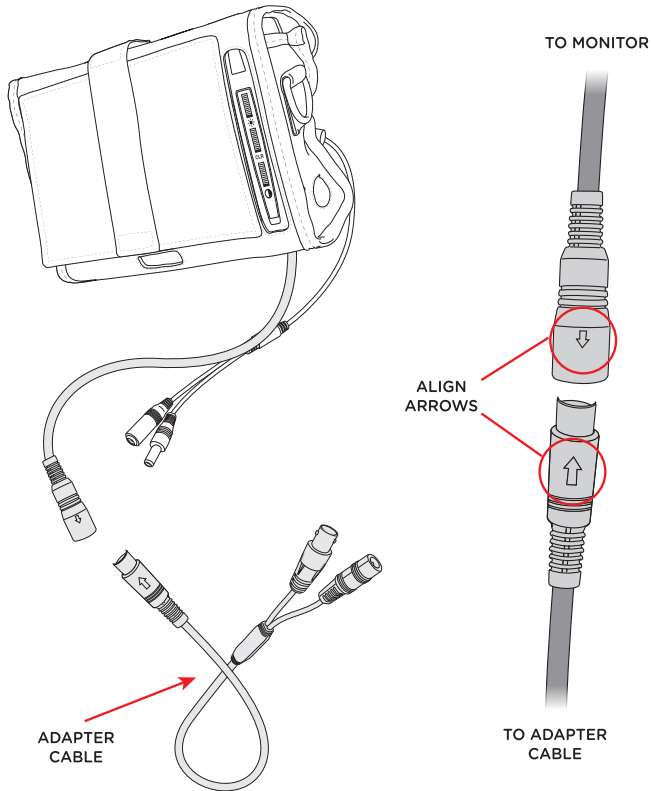

2. CONNECT POWER

Connect the power lead from the adapter cable to the power source; either the battery or the DC12V power supply.

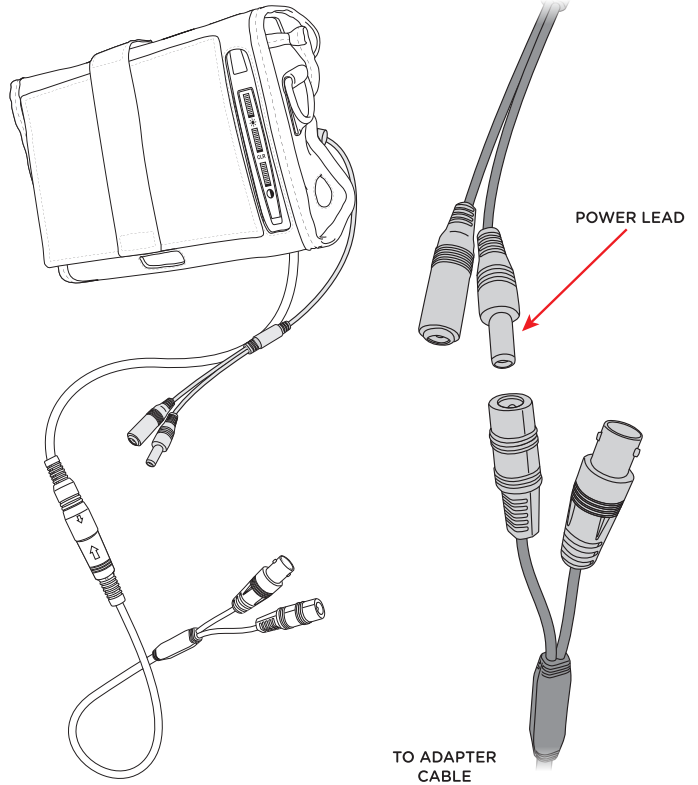

3. CONNECT VIDEO

BNC. To attach the BNC end of a camera to the BNC end of the monitor you will need a BNC (male) to BNC (male) adapter or a BNC Jumper Cable.

To make a BNC Jumper Cable; attach 2 BNC (male) connectors to either ends of a length of RG59 coax cable.



RCA. Use the supplied BNC to RCA Adapter if attaching to a camera with a RCA lead.

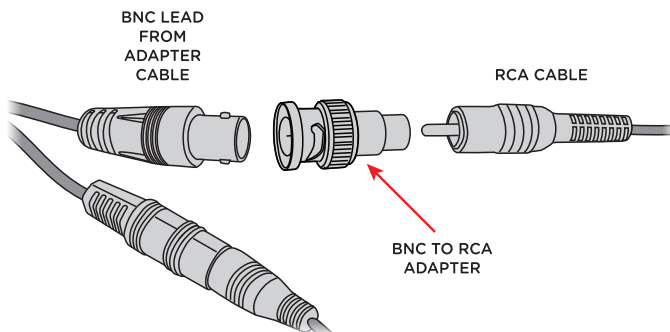

4. POWER ON

Battery. First set the switch on the battery to the ON position (red LED down on switch). Then press the grey POWER button on the face of the monitor.

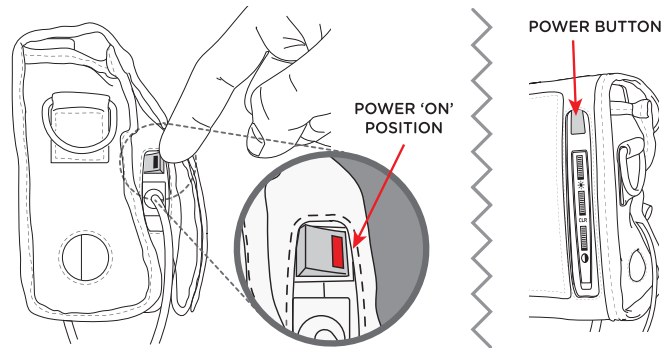

DC12V. Push the grey POWER button on the face of the monitor.

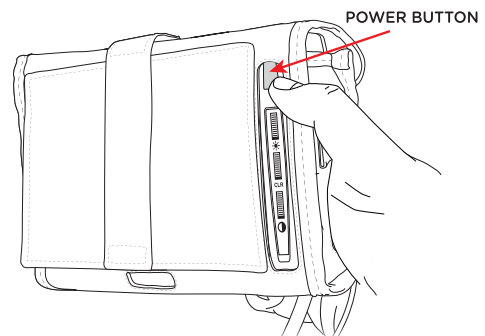

5. SUNSHIELD

Open the sunshield on the monitor bag and secure the position by using the velcro-backed strap. Remove protective film from monitor.

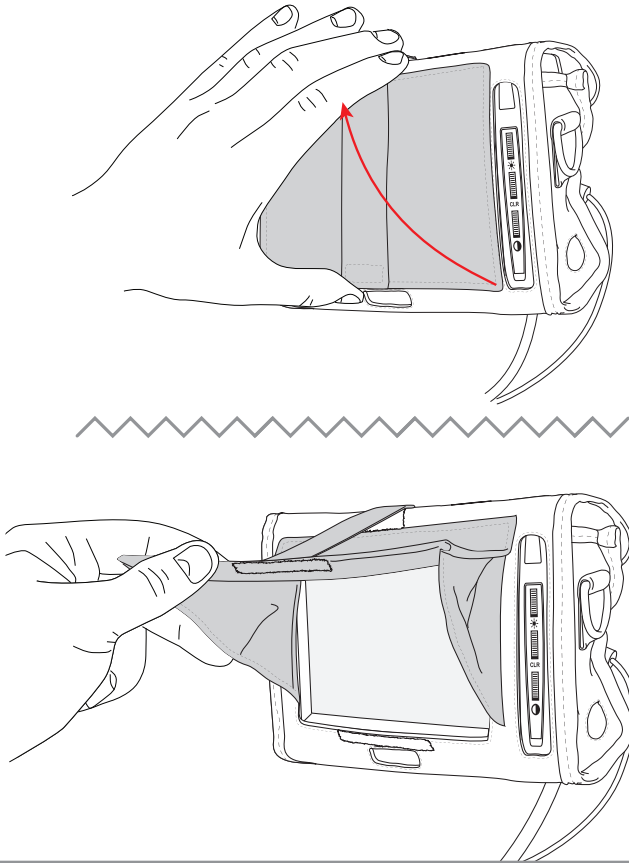

6. SCREEN ADJUSTMENTS

Adjust the monitor settings as needed by using the dials on the front of the monitor. Brightness, Color and Contrast are adjustable.

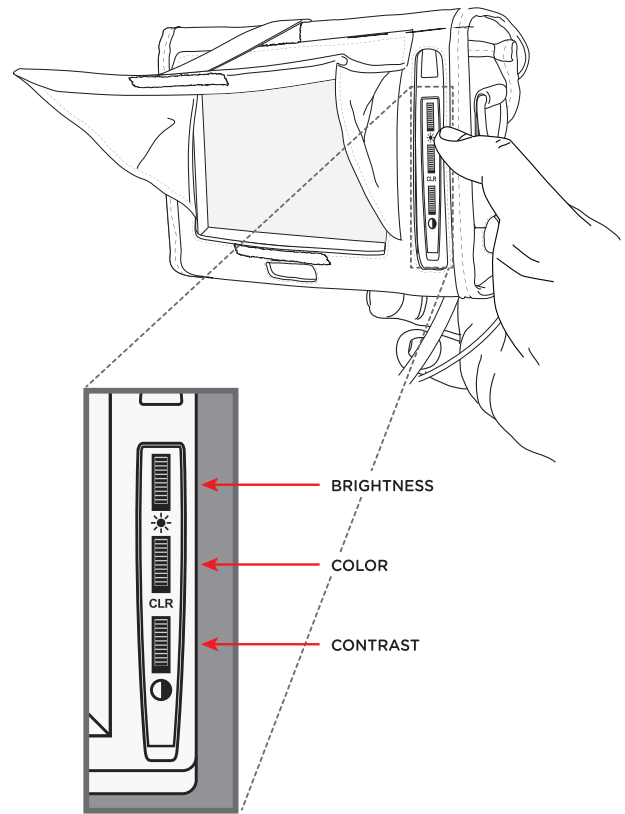

7. BATTERY CHARGING

To charge the battery, plug the battery charger cable into the battery cable from the battery. Set the battery switch to the ON position (red LED down on switch). When connected properly the LED on the charger will change from GREEN to RED. When fully charged (after approximately 8 hours) the LED on the charger will go back to GREEN.

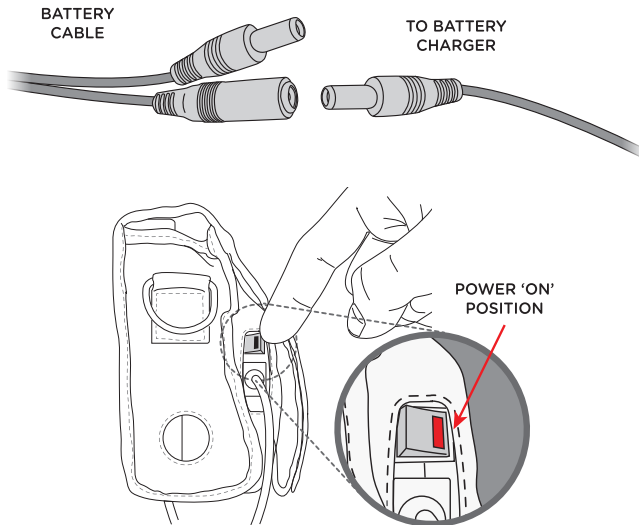

WARNING!

While it is possible to power the monitor using the battery charger and/or charge the battery with the DC12V power supply, doing so could damage the product and will void the warranty.

8. WRIST or SHOULDER STRAP

WRIST STRAP. Place wrist in wrist strap on the back of the monitor bag and tighten.

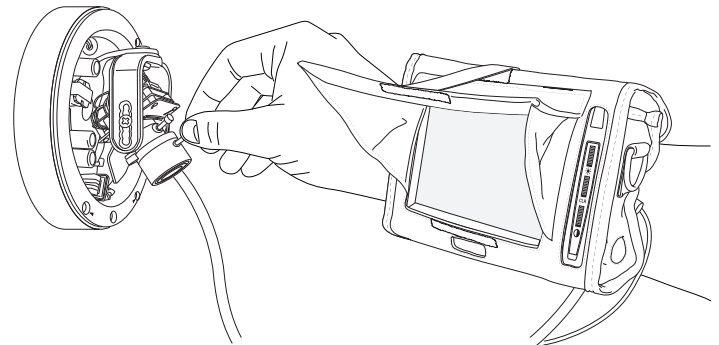

SHOULDER/NECK STRAP. The strap doubles as a shoulder strap for carrying the monitor or as a neck strap for hands-free viewing of the monitor.

