

CE-REMOTE

USER GUIDE

- Enables OSD Menu Control And Test Monitor Output
- Plugs Directly Into Camera DIN Port
- Long Cable For Ease Of Use
- No Batteries Required To Operate

*Only compatible with CE-REMOTE DIN Port equipped cameras

DOME CAMERAS

Remove dome cover, locate OSD Connection and insert OSD Connection end of CE-REMOTE cable.

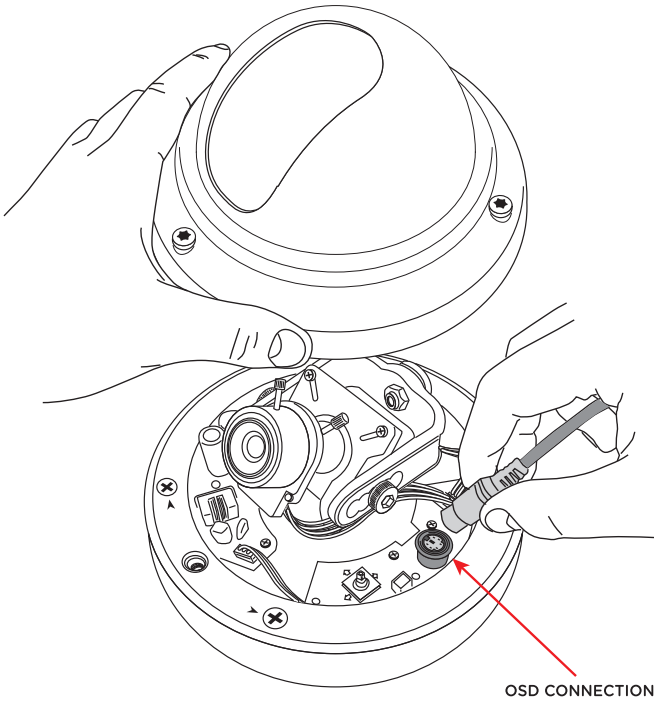

NOTE: Refer to the camera's installation guide for more detailed instructions on removing the dome cover and OSD Connection locations.

TURRET CAMERAS

Remove the cap located on the underside of the camera. Plug the CE-REMOTE into the OSD connection.

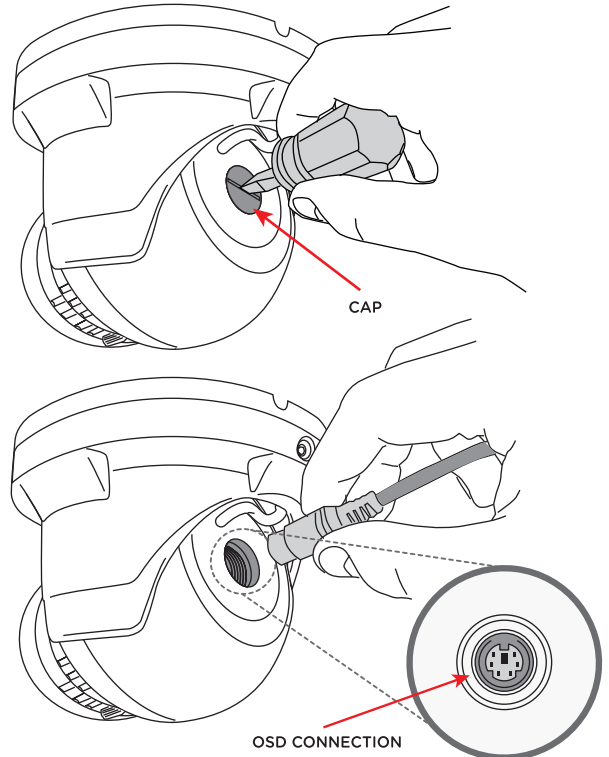

NOTE: Refer to the camera's installation guide for more detailed instructions on removing the OSD Connection cap and locations.

BULLET CAMERAS

Unscrew the cap located on the underside of the camera body. Plug the CE-REMOTE into the OSD connection.

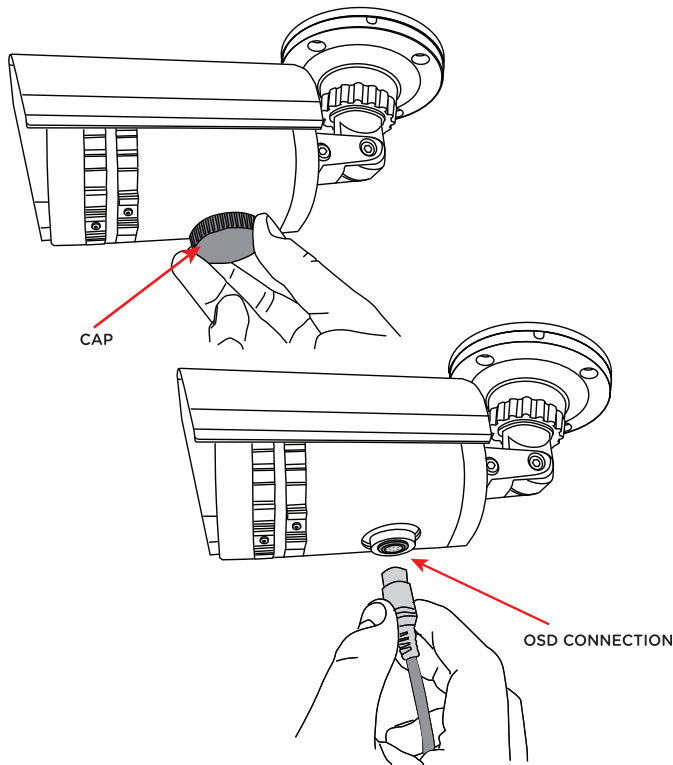

NOTE: Refer to the camera's installation guide for more detailed instructions on removing the OSD Connection cap and locations.

TEST MONITOR CONNECTION

Connect your test monitor to the BNC connection located on the CE-REMOTE cable lead.

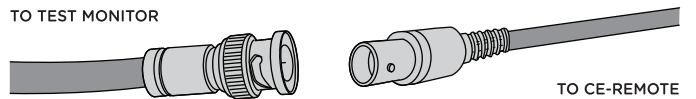

To activate OSD control press the SETUP button. (hold the SETUP button for 2 seconds on the PIXIM Seawolf). Scroll through the OSD Menu using the directional buttons. Refer to the OSD User Manual for detailed instructions on adjusting camera settings.

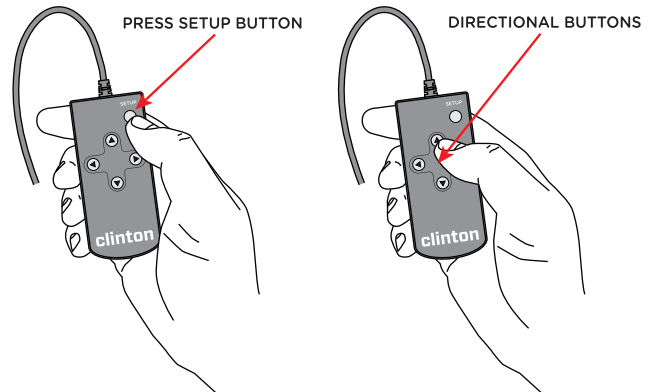

NOTE: Depending on type of camera, replace either dome cover or cap after OSD adjustments are complete.

CE-REMOTE-UTC

USER GUIDE

- Enables OSD Menu Control via Up the Coax* or Camera DIN Port**
- Plugs Directly into Coax Cable stream
- Long Cable for Ease of Use

*UTC Only compatible with NX4, S6, & Seawolf based cameras

**Only compatible with CE-REMOTE DIN Port equipped cameras

STEP 1

At a BNC connection point, such as the DVR or monitor, disconnect the cable from the desired camera.

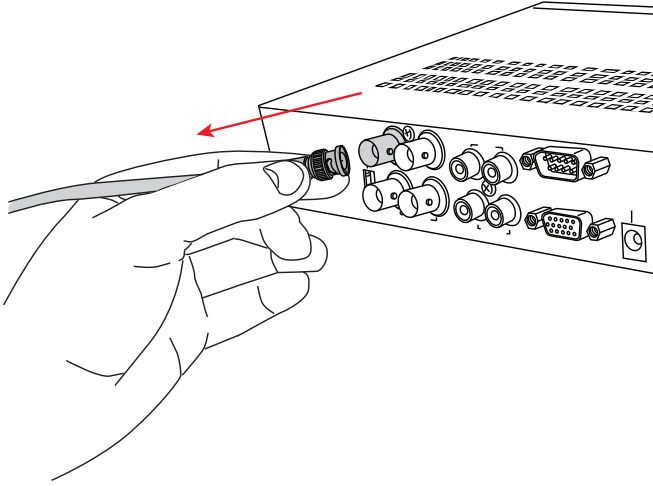

STEP 2

Connect the male BNC connection from the camera to the female BNC connection on the CE-REMOTE-UTC. Connect the male BNC connection from the CE-REMOTE-UTC into the previously disconnected source.

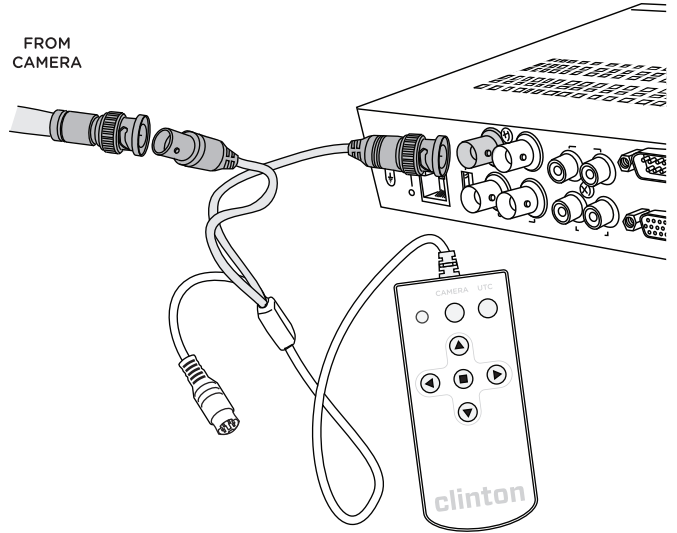

STEP 3

Press the 'UTC' button, the blue LED will light up. Then press the center button on the D-Pad, (or press and hold depending on the camera's OSD function) and the OSD menu will be displayed.

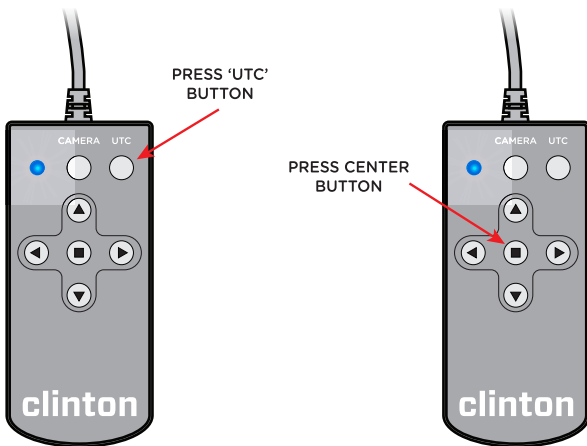

Scroll through the OSD Menu using the directional buttons. Refer to the OSD User Manual for detailed instructions on adjusting camera settings.

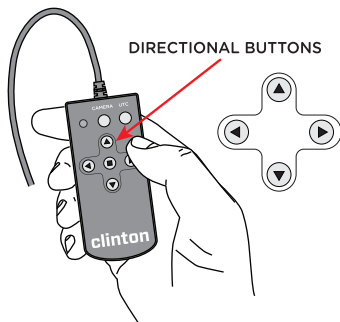

NOTE: Depending on the length of coax cable, button response times may vary.

OPTIONAL CAMERA CONNECTION

The CE-REMOTE-UTC can also be used on a non-UTC camera that has a DIN port. See CE-REMOTE User Guide for connection instruction.

Press the 'CAMERA' button on the CE-REMOTE-UTC, then press the center button to access the OSD menu.

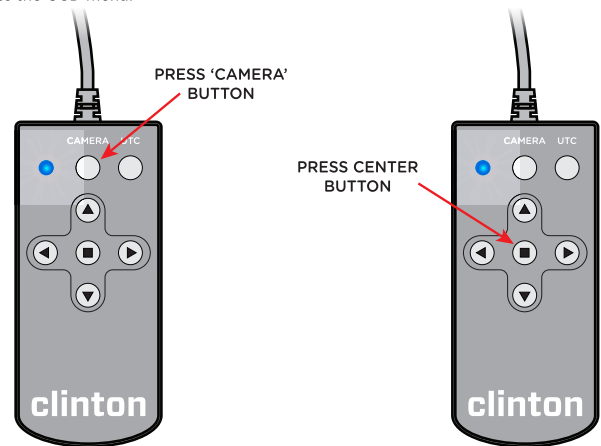

NOTE: If the blue LED does not light up when either 'UTC' or 'CAMERA' buttons are pressed, the battery may need to be replaced. Replace with CR2025 3V battery.

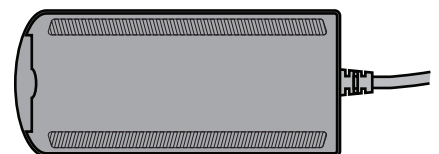
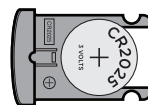

BACKSIDE OF CE-REMOTE-UTC