

CE-B707 Outdoor IR Anti-Spider Bullet Camera



INFO:

- 1/3" SONY 1.3 Megapixel CMOS Exmor Sensor
- 1,000 TVL Resolution
- 35 IR LEDs
- 3.5-16mm (F1.2) Lens (Externally Adjustable)
- S7 Digital Signal Processor (DSP)
- OSD Menu Control via CE-REMOTE
- 3 Axis Adjustment
- IP66 Weather Rated
- Cable Through Bracket Design with Mounting Plate
- DC12V/AC24V
- UL Listed

DIMENSIONS:

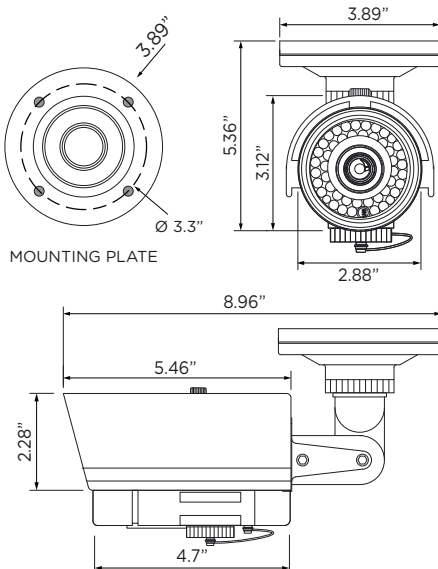

SPECIFICATIONS:

| Camera | |
|-----------------------|---|
| Image Sensor | 1/3" SONY 1.3 Megapixel CMOS Exmor Sensor |
| Resolution | 1,000 TVL |
| Effective Pixels | 1305 (H) x 1049 (V), 1.37M Pixels |
| Scanning System | Progressive |
| S/N Ratio | 52dB |
| Sync System | Internal |
| Minimum Illumination | 0.00001 Lux (Sens-Up x64) |
| Shutter Speed | 1/60 - 1/60,000 sec. |
| Dynamic Range | N/A |
| Lens | 3.5-16mm (F1.2) Lens (Externally Adjustable) |
| Video Output | 1.0 Vp-p, 75Ω |
| Frequency | Horizontal: 15.734 KHz, Vertical: 59.94 Hz |
| Power Consumption | Max. 600mA (DC12V), Max. 400mA (AC24V) |
| Power Requirement | DC12V / AC24V |
| Operating Temperature | -20°F - 122°F / -28°C - 50°C |
| Operating Humidity | 90% RH Max. |
| Weather Rating | IP 66 |
| IR LEDs | 35 IR LEDs |
| Heaters/Fan | N/A |
| Materials | Aluminum |
| Dimensions | 8.96" (L) x 5.36" (H) / 227.58mm (L) x 136.14mm (H) |
| Weight | 2.5 lbs / 1,133.98g |

| OSD | |
|-----------------------------|---|
| DSP Type | S7 |
| Menu Control | OSD Menu Control via Built-In Joystick or CE-REMOTE |
| Exposure | Brightness, Shutter, AGC |
| Sens-Up | Yes (x2 - x64) |
| White Balance | ATW, AWB, AWC-Set, Manual |
| Digital Dynamic Range | Yes |
| Backlight Control | BLC, HLC, WDR |
| Day/Night | Auto, Color, B&W, External |
| Noise Reduction | 3DNR |
| Camera Title/ID | N/A |
| Sync | N/A |
| Monitor | View Angle (4:3 / 16:9) |
| Motion Detection | (Intelligent) 4 Zones |
| Privacy Masking | 15 Zones |
| Digital Image Stabilization | N/A |
| Dead Pixel Control | N/A |
| Digital Effects | Digital Zoom, D-WDR, Defog, Image Flip |
| Languages | English, Chinese, Japanese, Korean |
| Other | Sharpness, Gamma, Pedestal, Color Gain |

*Anti-Spider Technology emits a high frequency signal that detracts spiders from creating a web over the lens.

CERTIFICATIONS:

